

A

B

C

D

E

F

G

H

I

1

1

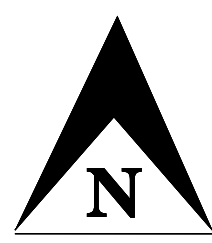

RICKWOOD
CAVERNS
STATE PARK

2

2

3

3

INSET 1

4

4

5

5

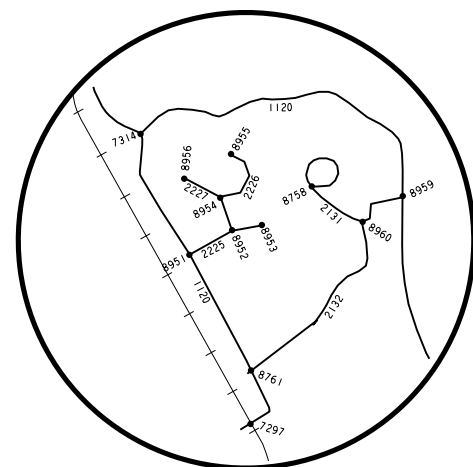

INSET 2

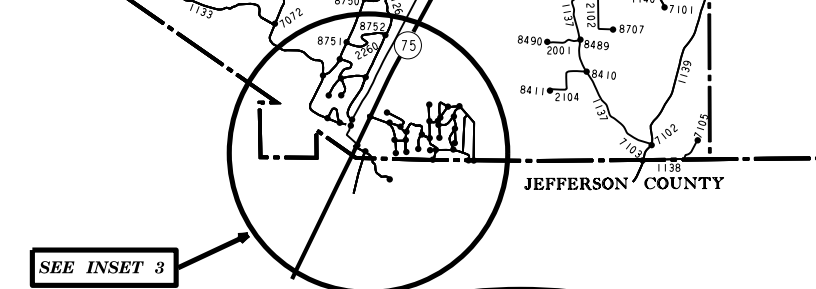

INSET 3

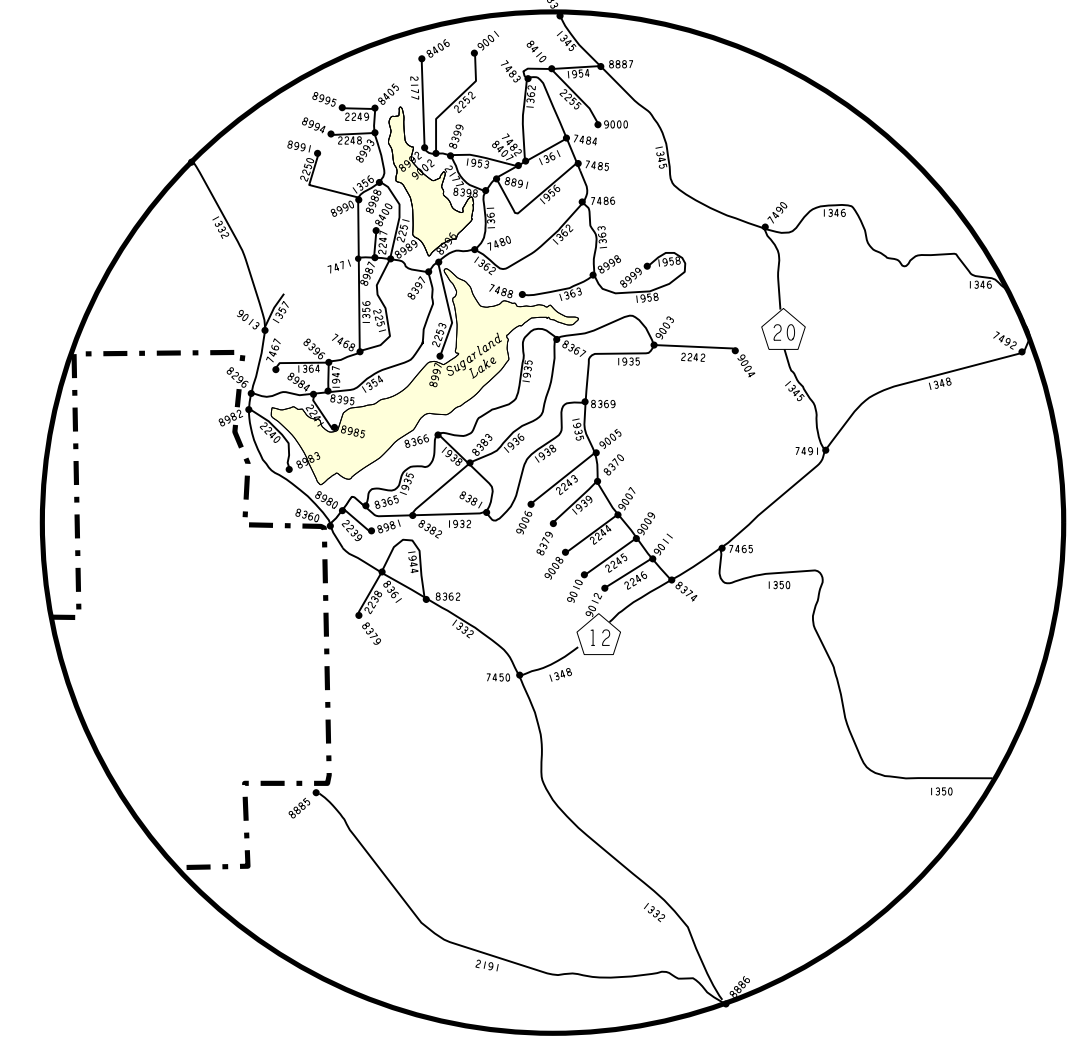

INSET 4

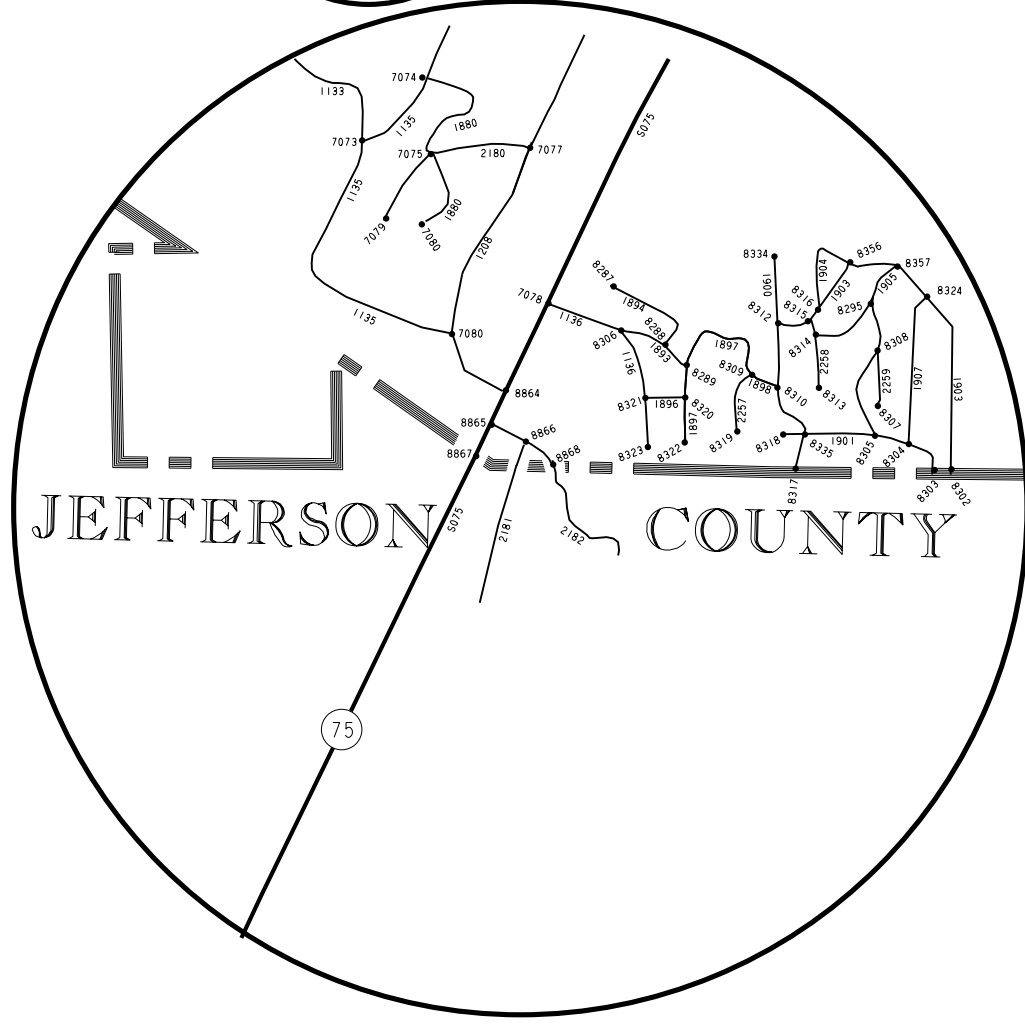

6

6

LINK-NODE REFERENCE MAP

BLOUNT COUNTY

LEGEND

- Node Symbol •
- Link Number 1686
- Node Number 8565
- Railroad
- County Limits
- Corporate Limits
- City Streets
- County Link Route
- State and U.S. Link Route

FOR ASSISTANCE IN SECURING INFORMATION ON ROUTES OR STREETS NOT SHOWN AND TO SECURE NEW LINK-NODE INFORMATION CALL AL. DEPT. OF TRANSPORTATION AT 242-6420 OR FAX REQUIREMENTS AT 242-6403 OR 242-0927

CITY BOUNDARIES ARE PLOTTED USING ALL AVAILABLE DESCRIPTIONS AT DATE OF REVISION. THE DEPARTMENT OF TRANSPORTATION CANNOT ACCEPT RESPONSIBILITY FOR INACCURACIES RESULTING FROM UNOBTAINABLE OR UNKNOWN DATA.

THIS MAP HAS BEEN PREPARED FROM FEDERAL, STATE AND LOCAL SOURCES. THE ALABAMA DEPARTMENT OF TRANSPORTATION IS NOT RESPONSIBLE FOR INFORMATION OBTAINED FROM THESE SOURCES. CERTAIN INFORMATION ON THIS MAP MAY HAVE BEEN CHANGED OR REVISED SINCE THIS MAP WAS COMPILED.

SCALE

1.5 0 1.5 3.0 4.5 6.0 MILES

REVISIONS

FEATURE	DATE	GRID
ADDED LINKS TO 2318	ADDED NODES TO 9095	03/2008

ALABAMA

PREPARED BY THE ALABAMA DEPARTMENT OF TRANSPORTATION BUREAU OF TRANSPORTATION PLANNING & MODAL PROGRAMS SPECIAL STUDIES DIVISION IN COOPERATION WITH THE U.S. DEPARTMENT OF TRANSPORTATION FEDERAL HIGHWAY ADMINISTRATION

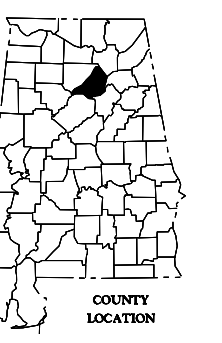

COMPILED FROM DATA AS OF NOVEMBER 2006

co005.JBT.DGN

7

7

A

B

C

D

E

F

G

H

I