

☐ DECK CONSTRUCTION JOINT AT BENT OR PIER LOCATIONS FOR SIMPLE SPAN BRIDGES WITH CONTINUOUS DECKS. SEE BRIDGE PLANS FOR DETAILS OF CONSTRUCTION JOINTS. ☐ BENT OR PIER FOR FULLY CONTINUOUS STRUCTURAL STEEL BRIDGES.

BARS C1 THRU C(X) (TOP AND BOTTOM) SPACED @ DIMENSION C AS SHOWN IN DECK TABLE. SEE BRIDGE PLANS FOR DETAILS OF BAR SERIES C1 THRU C(X)

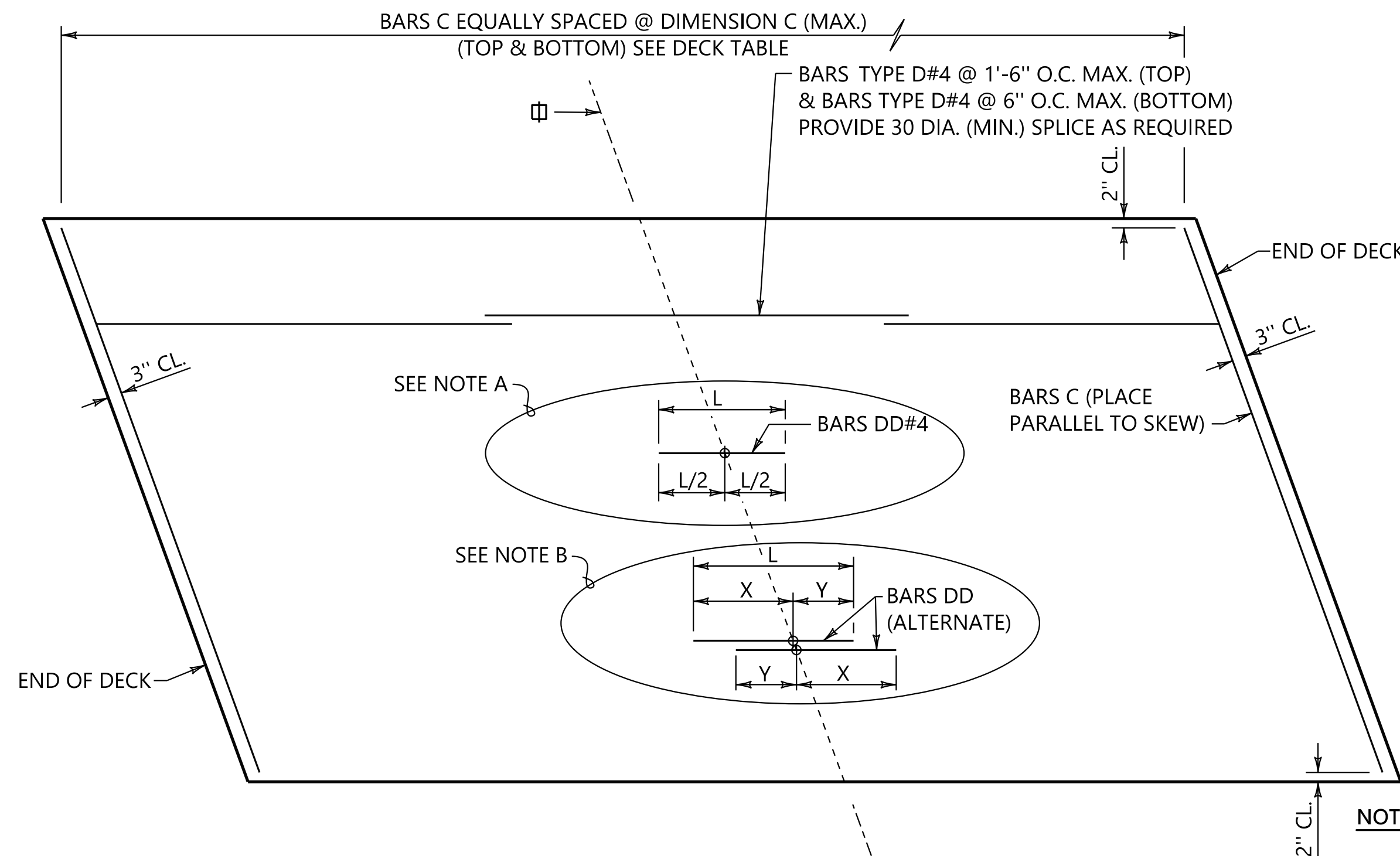

**PLAN, DECK REINFORCING (0° TO 25° SKEW)  
SIMPLE SPAN OR CONTINUOUS UNIT  
TANGENT OR CURVED**  
(SEE BRIDGE PLANS FOR SKEW ANGLE)

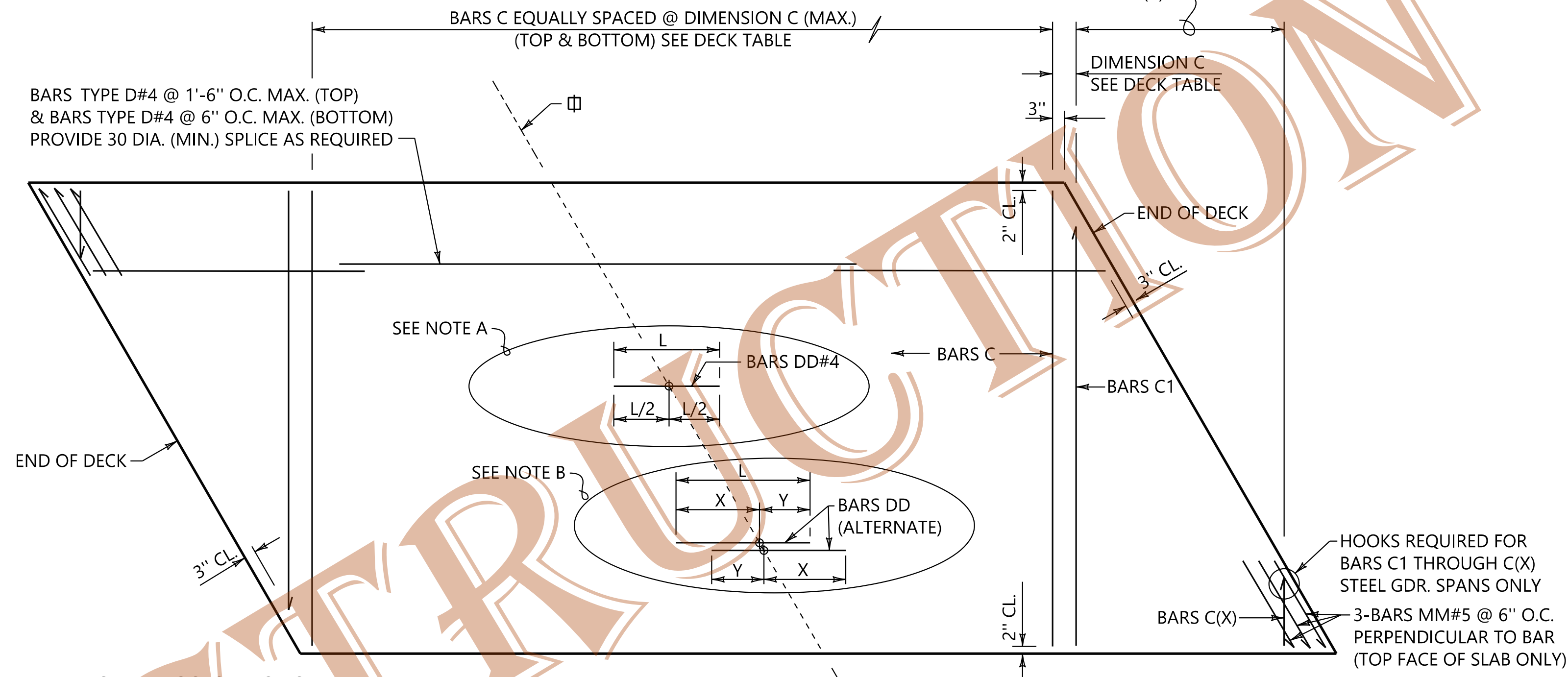

**PLAN, DECK REINFORCING (SKEW GREATER THAN 25°)  
SIMPLE SPAN OR CONTINUOUS UNIT  
TANGENT OR CURVED**  
(SEE BRIDGE PLANS FOR SKEW ANGLE)

**NOTE A:** PLACE SUPPLEMENTAL BARS DD#4 AS SHOWN ON SIMPLE SPANS WITH CONTINUOUS DECK ONLY (UNLESS OTHERWISE SHOWN ON BRIDGE PLANS). LENGTH L SHALL BE AS SHOWN ON BRIDGE PLANS.

**NOTE B:** PLACE SUPPLEMENTAL BARS DD AS SHOWN ON FULLY CONTINUOUS SPANS ONLY (UNLESS OTHERWISE SHOWN ON BRIDGE PLANS). LENGTH L, DIMENSIONS X AND Y AND BAR SIZE SHALL BE AS SHOWN ON BRIDGE PLANS.

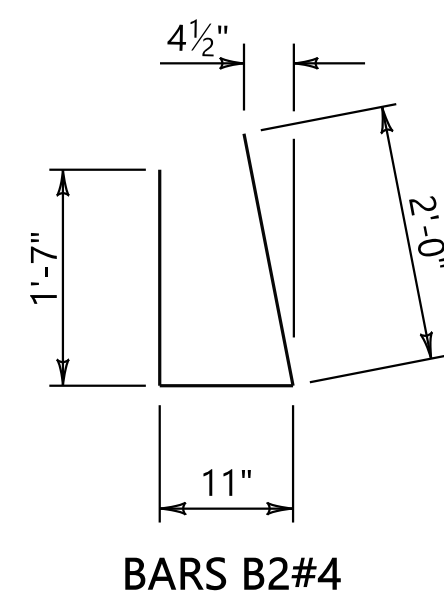

**BARS B2#4**

DECK TABLE				
DIMENSION S	BARS TYPE C SIZE	DIMENSION A	DIMENSION B	DIMENSION C
4'-0" ≤ S ≤ 10'-0"	#5	7"	1 3/4"	6"
10'-0" < S ≤ 14'-0"	#6	7 1/2"	2"	6"
14'-0" < S ≤ 16'-0"	#6	8"	2 1/2"	5"

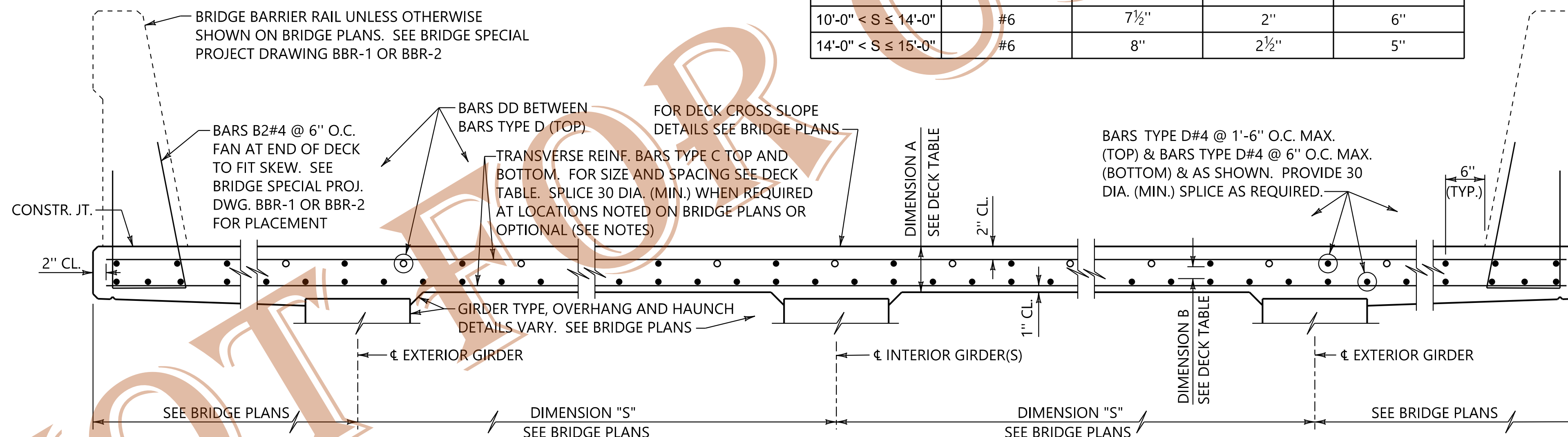

**TYPICAL DECK CROSS SECTION**

**NOTES:**

- SEE BRIDGE PLANS FOR BILL OF REINFORCEMENT AND BAR DETAILS NOT SHOWN.
- FOR BARS TYPE D, AT THE OPTION OF THE CONTRACTOR, AN ALTERNATE LAYOUT UTILIZING STOCK LENGTH BARS MAY BE SUBMITTED TO THE STATE BRIDGE ENGINEER FOR APPROVAL. FOR CONTINUOUS DECK UNITS, SPLICING OF BARS TYPE D WILL NOT BE PERMITTED WITHIN 10'-0" EITHER SIDE OF REQUIRED SLAB CONSTRUCTION JOINT OCCURRING AT BENT OR PIER LOCATIONS.
- FOR BARS TYPE C, AT THE OPTION OF THE CONTRACTOR, BARS MAY BE SPLICED 30 DIA. (MIN.) AT THE FOLLOWING LOCATIONS ONLY UNLESS APPROVED OTHERWISE BY THE STATE BRIDGE ENGINEER: FOR TOP BARS, CENTERED AT THE MIDPOINT BETWEEN GIRDERS. FOR BOTTOM BARS, CENTERED OVER THE CENTERLINE OF AN INTERIOR GIRDER ONLY. ESTIMATED QUANTITIES (SEE BRIDGE PLANS) DO NOT INCLUDE OPTIONAL SPLICES. ONLY ONE SPLICE PER BAR RUN WILL BE ALLOWED WITHOUT PRIOR APPROVAL OF THE STATE BRIDGE ENGINEER.
- CURVED ALIGNMENTS:  
BARS D: BARS TYPE D SHALL BE PLACED PARALLEL TO CURVATURE.  
BARS C: SPACING FOR BARS TYPE C SHALL BE BASED ON THE LONG SIDE OF THE SPAN WITH THE END POINT OF THE BAR DEFINING THE SPACING. BAR SPACING WILL DECREASE FROM THE LONG SIDE OF SPAN TO THE SHORT SIDE. FOR SKEWS GREATER THAN 25°, BARS TYPE C SHALL BE PLACED ALONG RADIAL LINES.
- THIS BRIDGE SPECIAL PROJECT DRAWING APPLICABLE ONLY WITH DECKS THAT HAVE PARALLEL EDGES, EQUAL SKEW ANGLES, NON-PHASED CONSTRUCTION. OTHERWISE, DECKS SHALL BE COMPLETELY DETAILED IN THE BRIDGE PLANS.

ASSISTANT BRIDGE ENGINEER <i>[Signature]</i> DATE: 1/20/23	BRIDGE ENGINEER <i>[Signature]</i> DATE: 1/20/23
--	--

