

NOTES

1. TRAFFIC PROTECTION SHALL BE TYPE 1 OR 2 AS APPROPRIATE. ALL CONSTRUCTION SHALL BE IN ACCORDANCE WITH STANDARD DRAWING BGN-1 NOTE NO. 13 OR BRIDGE SPECIAL PROJECT DRAWING SBN-1 NOTE NO. 13.
2. CLEARANCE FOR TRAFFIC PROTECTORS: THE CONTRACTOR WILL BE REQUIRED TO MAINTAIN THE CLEARANCES SUBMITTED UNDER REQUIREMENT OF STANDARD DRAWING BGN-1 NOTE NO. 13 OR BRIDGE SPECIAL PROJECT DRAWING SBN-1 NOTE NO. 13 DURING CONSTRUCTION.
3. TRAFFIC PROTECTORS SHALL BE ERECTED AHEAD OF THE FORMWORK FOR THE SUPERSTRUCTURE AND SHALL REMAIN IN PLACE UNTIL ALL POURING OVER THE PROTECTION HAS BEEN COMPLETED. FLAGMEN SHALL BE USED AS NEEDED TO PROTECT TRAFFIC DURING ERECTION AND REMOVAL OF THE PROTECTORS. FLAGMEN SHALL ALSO BE USED AS NEEDED DURING FINISHING AND PAINTING OPERATIONS OVER THE ROADWAY.

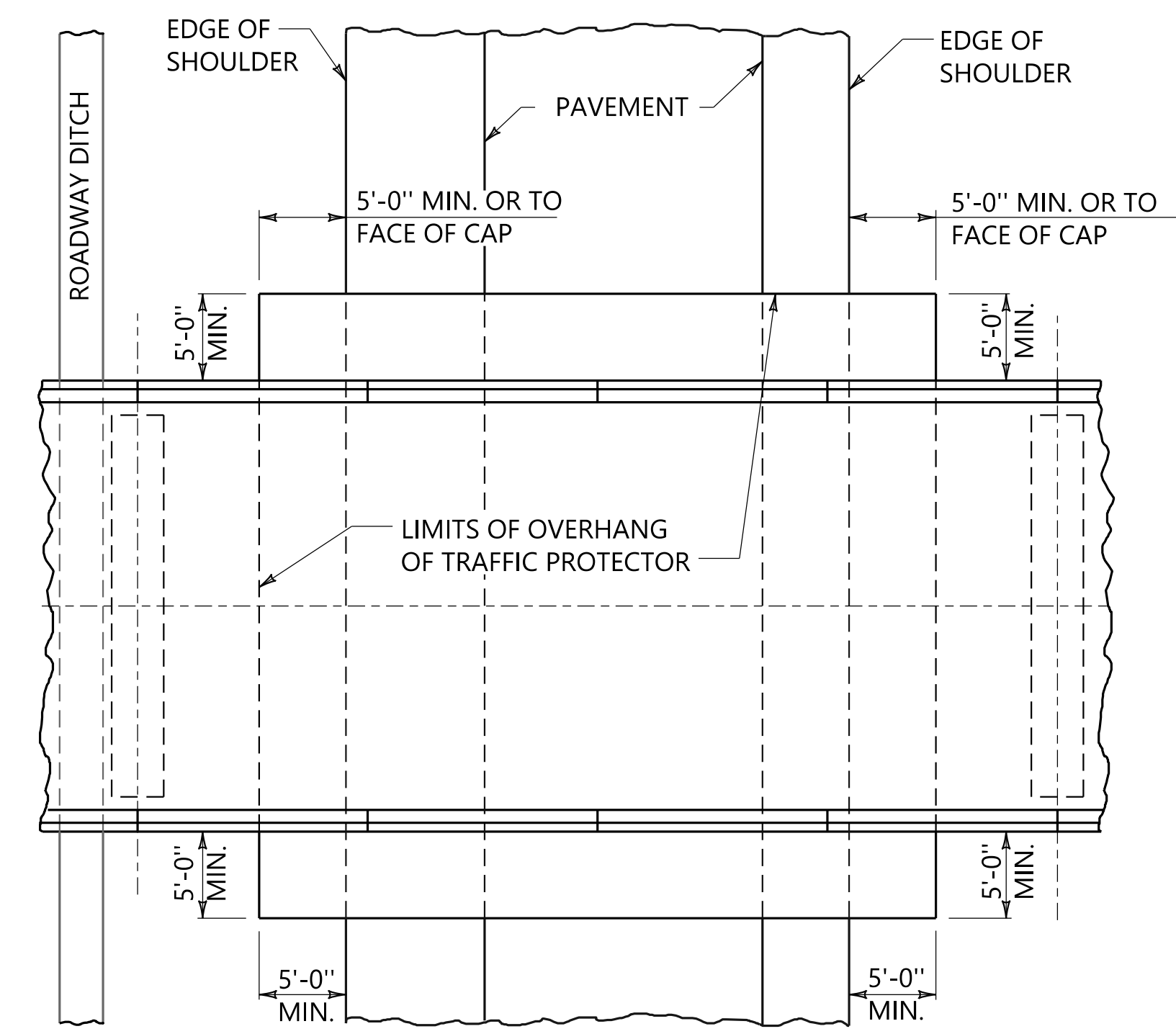

DITCH SECTION

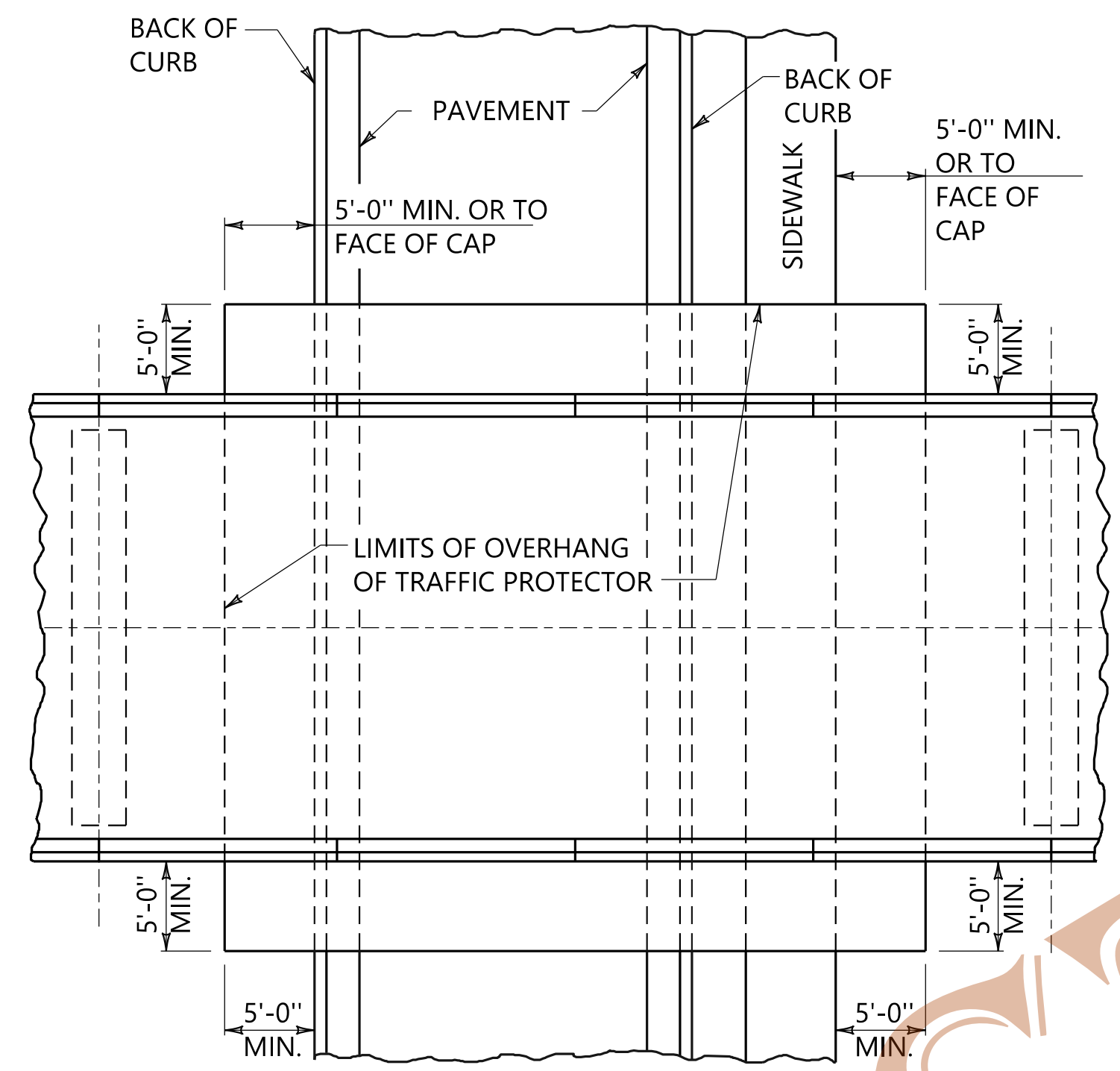

CURB & GUTTER SECTION

PLAN

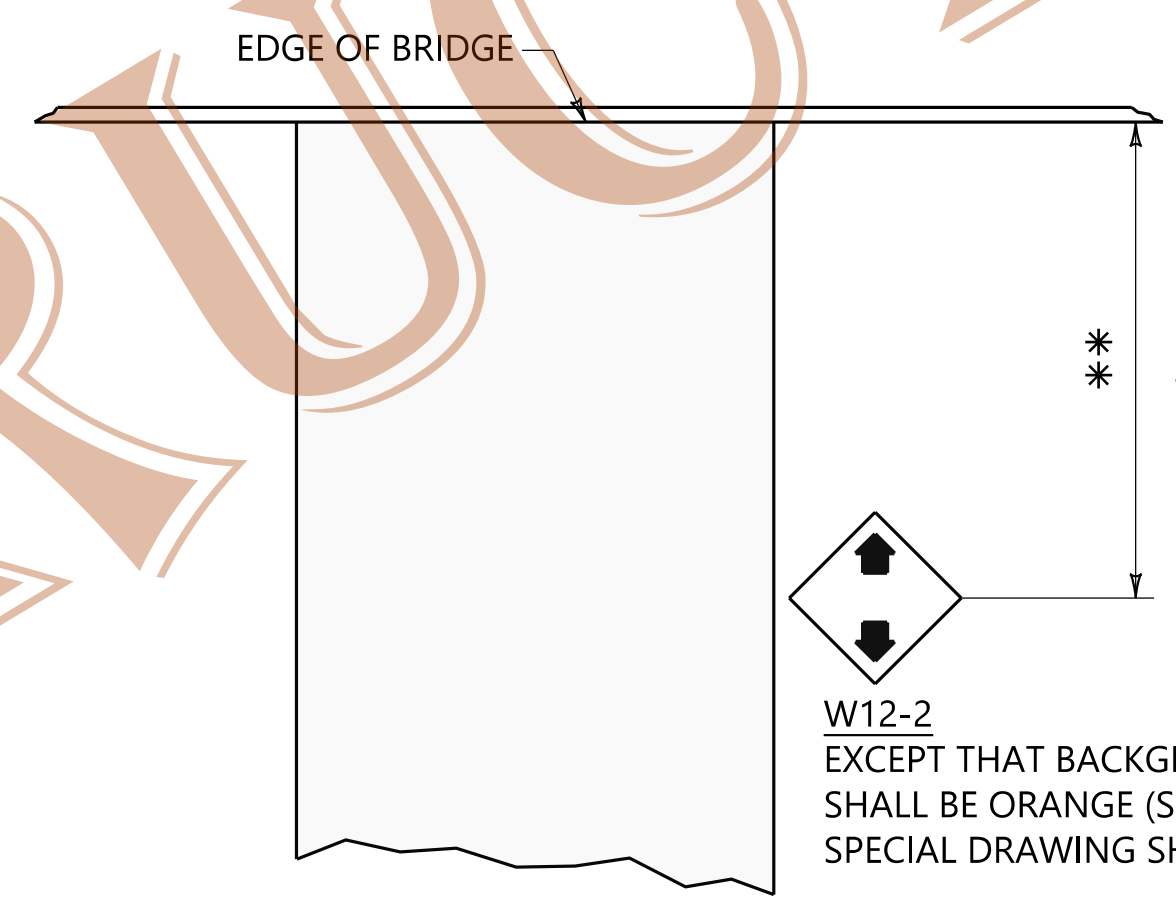

SIGN LOCATION DETAIL

NOTE: VERTICAL CLEARANCE SIGNS SHOWN AT LEFT SHALL BE INSTALLED IN ADDITION TO THE NORMAL REQUIRED ADVANCE WARNING SIGNS WHEN THE VERTICAL CLEARANCE IS LESS THAN 17'-0".

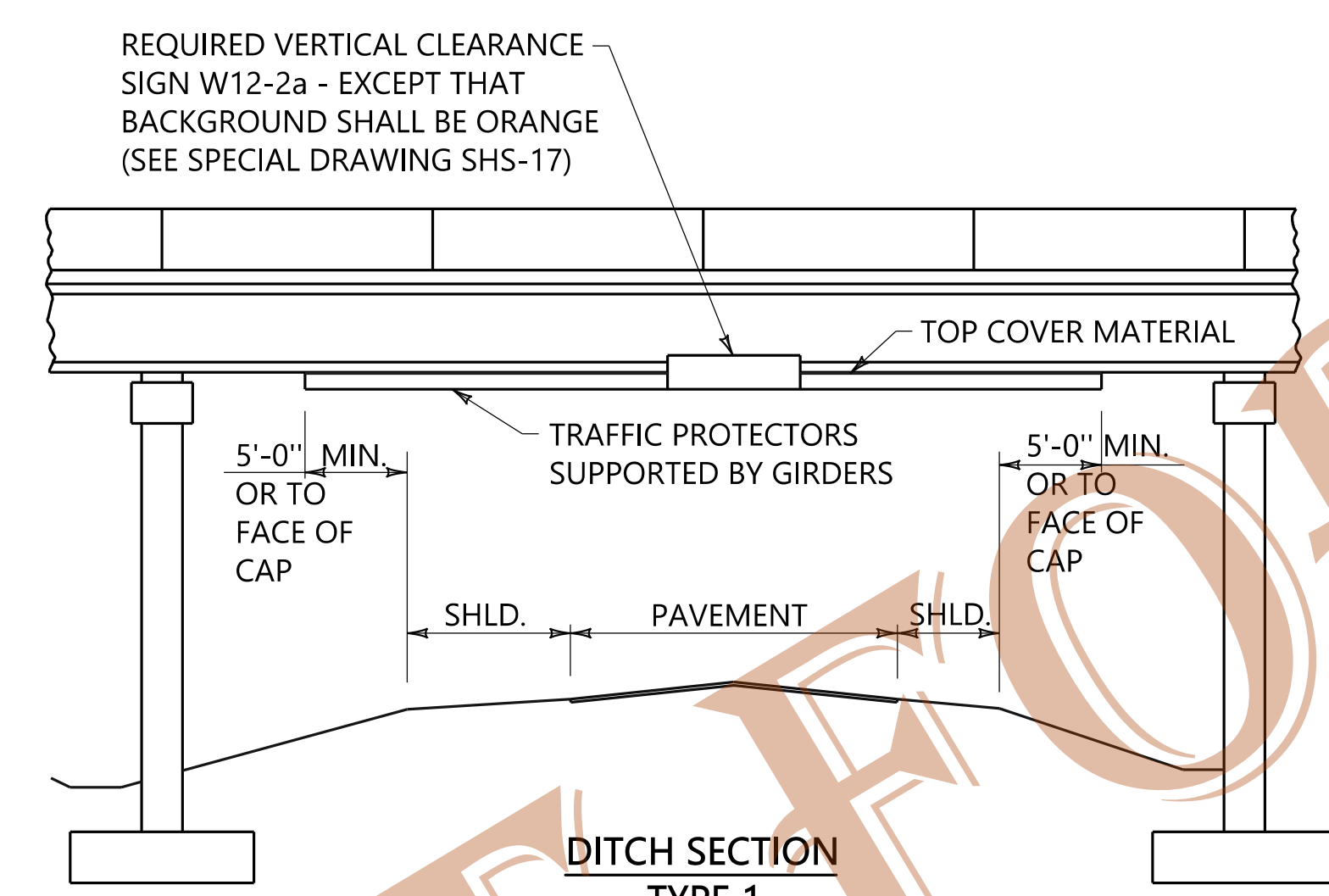

DITCH SECTION TYPE 1

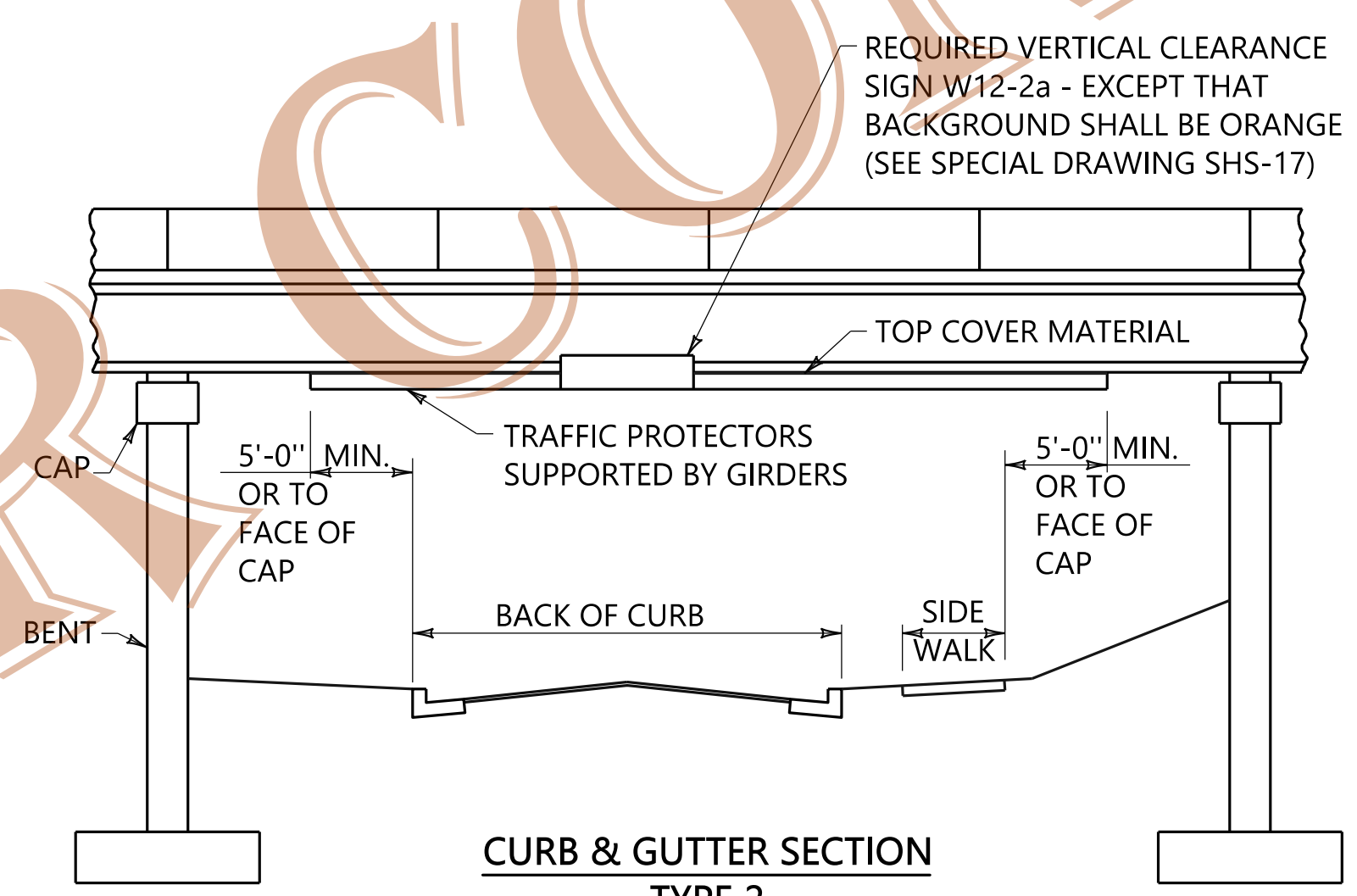

CURB & GUTTER SECTION TYPE 2

TRAFFIC PROTECTION ELEVATION

LEGEND

NO.'s & LETTERS-----BLACK (NON-REFL.)
BACKGROUND-----ORANGE (REFL.)

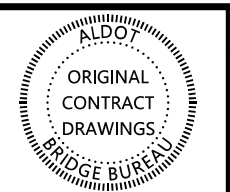

| REVISIONS |
|-----------|
| |

THIS BRIDGE SPECIAL PROJECT DRAWING FOR USE ONLY ON:
PROJECT NO. _____
COUNTY(S) _____

THESE DRAWINGS REPRESENT DESIGNS PREPARED FOR USE BY THE ALABAMA DEPARTMENT OF TRANSPORTATION AND ARE NOT TO BE COPIED, REPRODUCED, ALTERED, OR USED BY ANYONE, OR ANY ORGANIZATION, WITHOUT THE EXPRESSED WRITTEN CONSENT OF THE ALABAMA DEPARTMENT OF TRANSPORTATION REPRESENTATIVE AUTHORIZED TO APPROVE SUCH USE. ANYONE MAKING UNAUTHORIZED USE OF THESE DRAWINGS MAY BE PROSECUTED TO THE FULLEST EXTENT OF THE LAW.

TRAFFIC PROTECTION

| | |
|---|---|
| ASSISTANT BRIDGE ENGINEER <i>[Signature]</i> DATE: 11/29/20 | BRIDGE ENGINEER <i>[Signature]</i> DATE: 11/20/20 |
|---|---|

BRIDGE SPECIAL PROJECT DRAWING
TP-1
SHEET 1 OF 1