

4

BILL WODDAIL LATARA BURTON DANIEL JONES

22	MOBILE AREA IN PLACE PERSONNEL
23	TL/ATL IN PLACE
26	READY TO IMPLEMENT
30	NOTIFY TL TO BEGIN PROCEDURE
40	ATL ARRIVES AT TYPE B INTERCHANGE
48	ATL ARRIVES AT TYPE B INTERCHANGE
57	ATL'S NB HAVE PASSED
59	INTERCHANGE CLEAR
67	TRAFFIC REVERSED
104	INTERCHANGE CLEAR
114	TRAFFIC NORMAL

LOCATION	PERSONNEL	CLASS	TRUCK NUMBER	CELL NO.	MISC. EQUIPMENT
Site 4 Exit 37 SR-287 (CR-47)	JEREMY WASHINGTON	TMT III-CL	ST-17957 PICKUP	251-331-2445	W/ TRAILER
	JO SIMMONS	TMT III	ST-17373 CREW CAB	251-331-0755	W/ VMS
	WILLIE MIMS	TMT II			
	MACKS HASTINGS	TMT II	ST-17188 FLAT CREW CAB		ARW BRD
	RICKY HENMAN	TMT I			

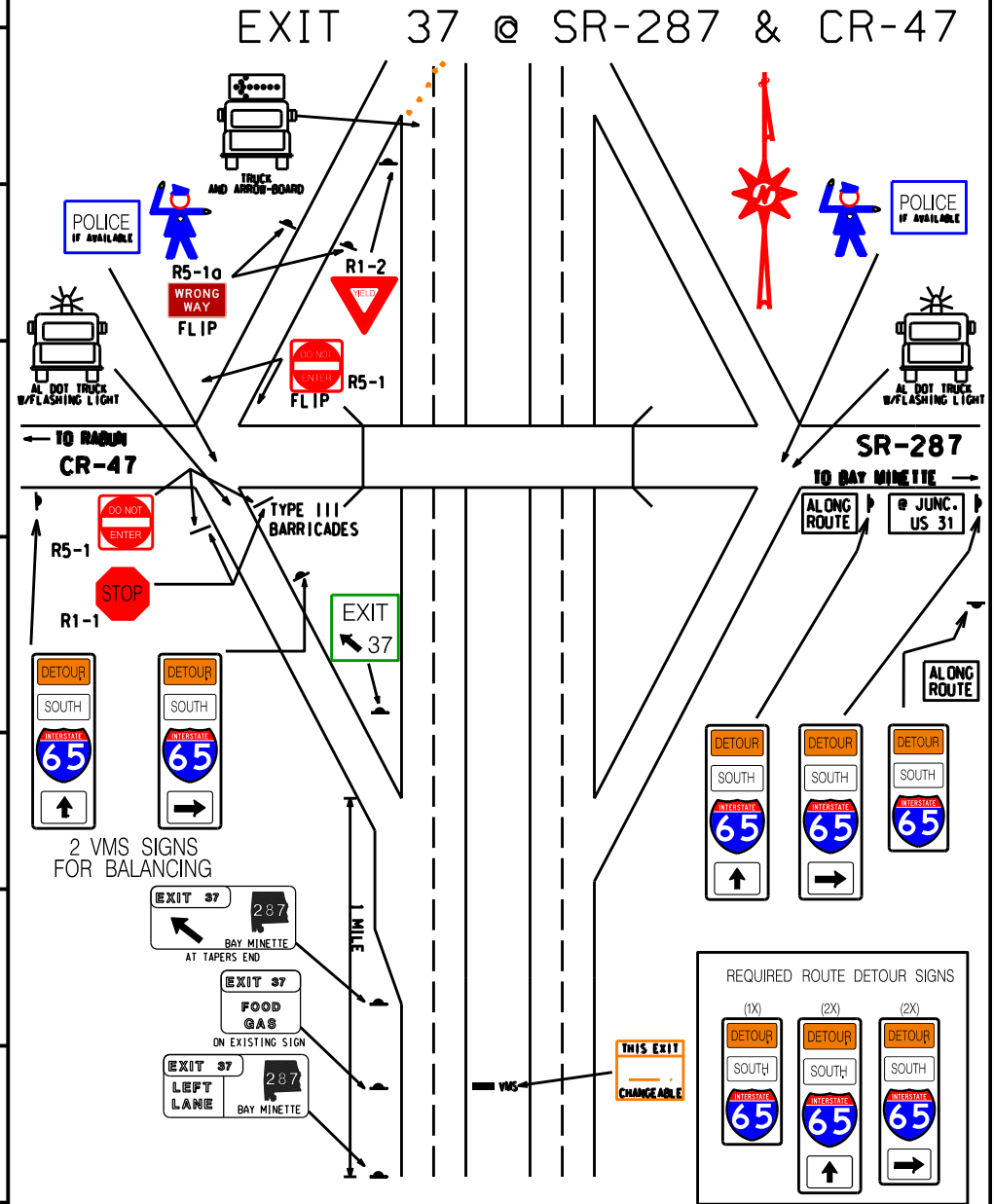

- REQUIRED**
- 2 TYPE III BARRICADES W/ STOP SIGNS W/ DO NOT ENTER
 - 1 YIELD SIGNS
 - 2 LAW ENFORCEMENT
 - 5 ROUTE DETOUR SIGNS
 - 1 EXIT AHEAD SIGNS
 - 1 EXIT LT. LN. SIGN
 - 1 EXIT SERVICES SIGN
 - 1 EXIT ARROW SIGN
 - 2 ALL TRAFFIC MUST EXIT 1/2 MILE SIGNS
 - 2 ALL TRAFFIC MUST EXIT 1 MILE SIGNS

NOTE : COVER ALL INAPPROPRIATE SIGNS

