

13

BRIAN LATHAM

BRETT PAULK

22	MOBILE AREA IN PLACE PERSONNEL
23	TL/ATL IN PLACE
26	READY TO IMPLEMENT
30	NOTIFY TL TO BEGIN PROCEDURE
40	ATL ARRIVES AT TYPE B INTERCHANGE
48	ATL ARRIVES AT TYPE B INTERCHANGE
57	ATL'S NB HAVE PASSED
59	INTERCHANGE CLEAR
67	TRAFFIC REVERSED
104	INTERCHANGE CLEAR
114	TRAFFIC NORMAL

LOCATION	PERSONNEL	CLASS	TRUCK NUMBER	CELL NO.	MISC. EQUIPMENT
Site 13 Exit 93 US-84	JUSTIN BOOKER	TMT I-CL	ST-14301 CREWCAB	251-895-0210	TM/ARROW BOARD
	RAMOAN KING	TMT II	ST-18184 PICKUP		W/VMS
	PRESTON REED	TMT I			W/VMS
	BRENDA STALLWORTH	TT	ST-17510	251-895-1902	

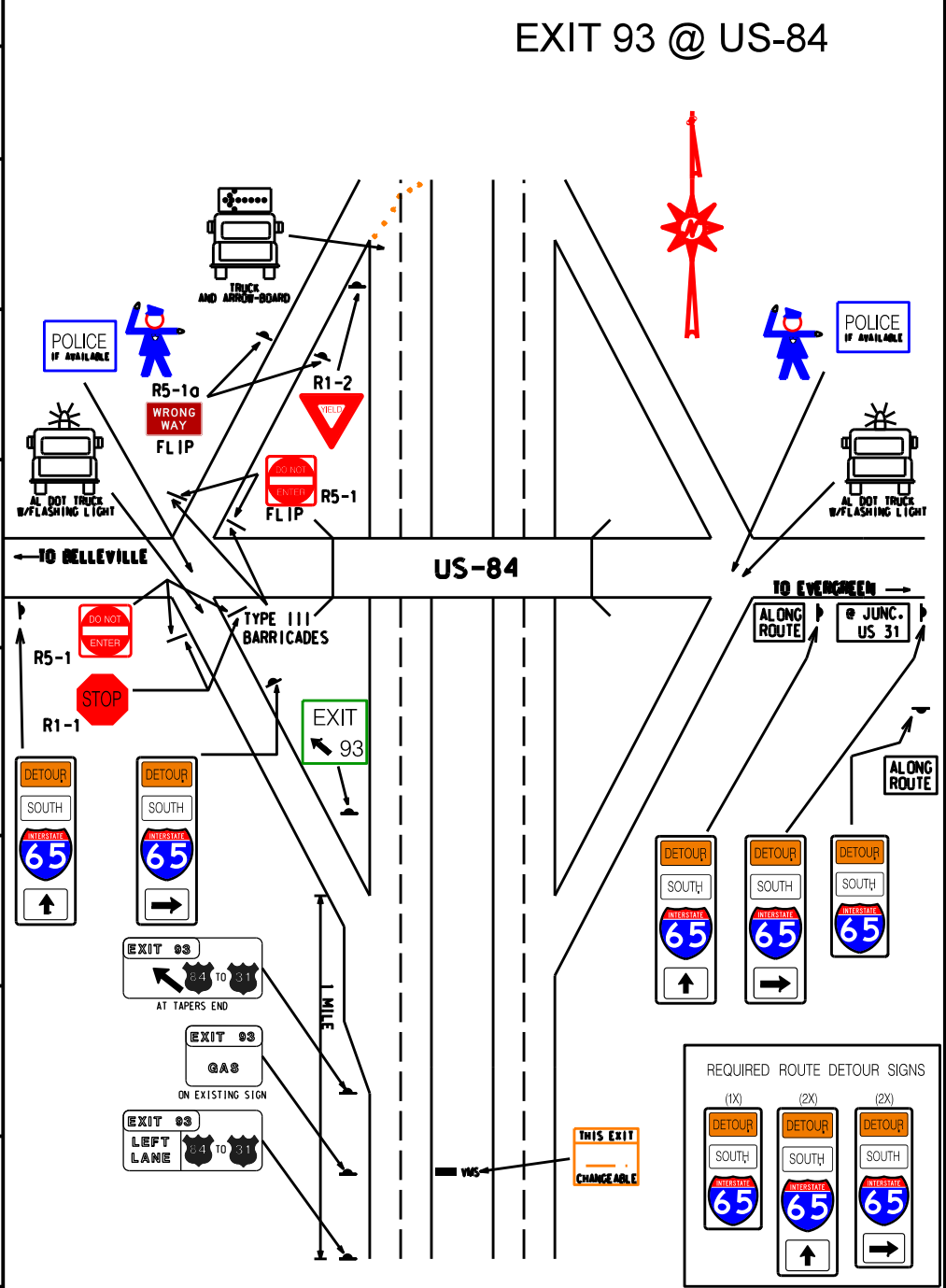

- REQUIRED**
- 2 TYPE III BARRICADES W/STOP SIGNS W/DO NOT ENTER
 - 1 YIELD SIGNS
 - 2 LAW ENFORCEMENT
 - 5 ROUTE DETOUR SIGNS
 - 1 EXIT AHEAD SIGNS
 - 1 EXIT LT. LN. SIGN
 - 1 EXIT SERVICES SIGN
 - 1 EXIT ARROW SIGN
 - 2 ALL TRAFFIC MUST EXIT 1/2 MILE SIGNS
 - 2 ALL TRAFFIC MUST EXIT 1 MILE SIGNS

NOTE : COVER ALL INAPPROPRIATE SIGNS