

A

B

C

D

E

F

G

H

I

1

1

2

2

3

3

4

4

5

5

6

6

7

7

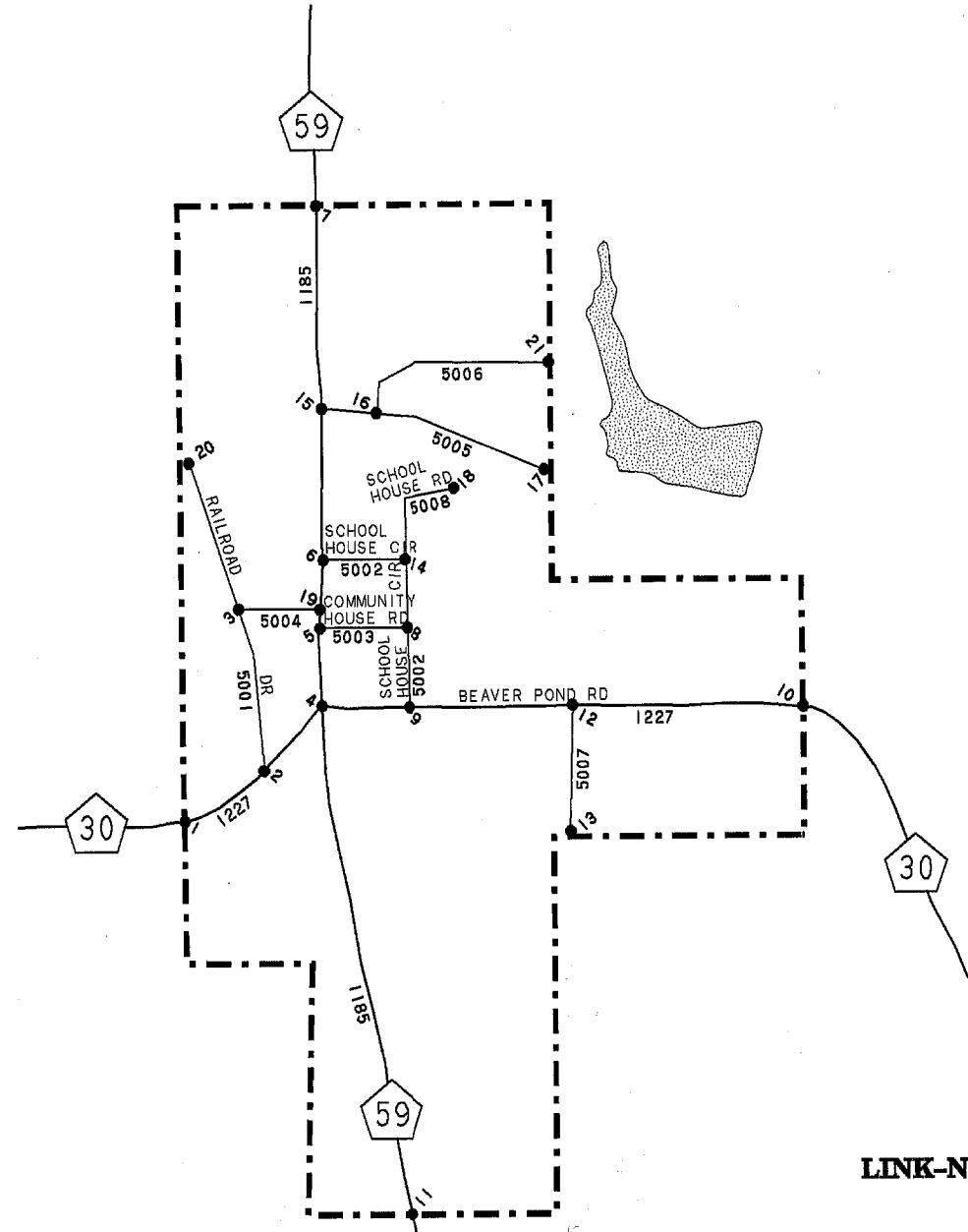

FOR ASSISTANCE IN OBTAINING INFORMATION  
ON ROUTES OR DISTANCES SEE MAPS  
AND TO OBTAIN ANY LEGAL INFORMATION  
CALL ALABAMA DEPARTMENT OF TRANSPORTATION  
OR THE ENGINEERS AT 540-6005 OR 540-6007

CITY BOUNDARIES ARE PLOTTED  
USING ALL AVAILABLE INFORMATION AT  
DATE OF REVISION. THE DEPARTMENT OF TRANSPORTATION  
CANNOT ASSUME RESPONSIBILITY FOR  
MISPLACEMENT OF BOUNDARIES FROM UNRELIABLE  
OR OUTDATED DATA

THIS MAP HAS BEEN PREPARED  
FROM FEDERAL, STATE AND LOCAL SOURCES.  
THE ALABAMA DEPARTMENT OF  
TRANSPORTATION IS NOT RESPONSIBLE FOR  
INFORMATION OBTAINED FROM THESE SOURCES  
CERTAIN INFORMATION ON THIS MAP MAY HAVE BEEN CHANGED  
OR REVISED SINCE THIS MAP WAS COMPILED

**REVISIONS**

| FEATURE | DATE | GRID |
|---------|------|------|
|         |      |      |
|         |      |      |
|         |      |      |
|         |      |      |
|         |      |      |
|         |      |      |
|         |      |      |
|         |      |      |

**LEGEND**

- Node Symbol •
- Link Number 1656
- Node Number 8565
- Corporate Limits - - - - -
- City Streets ————
- County Link Route —○—○—
- State and U.S. Link Route —○—○—

SCALE



**LINK-NODE REFERENCE MAP**

**PETREY**

**ALABAMA**

PREPARED BY THE  
ALABAMA DEPARTMENT OF TRANSPORTATION  
BUREAU OF TRANSPORTATION PLANNING & MODAL PROGRAMS  
SPECIAL STUDIES DIVISION  
IN COOPERATION WITH THE  
U.S. DEPARTMENT OF TRANSPORTATION  
FEDERAL HIGHWAY ADMINISTRATION



COMPILED FROM DATA AS OF  
OCTOBER 2005

59328TGE.DGN