

NH-0003(621)
 Resurfacing, Planing, Striping, Patching, and
 2' Safety Widening on SR-3(US-31) from
 I-65 to CR-68 (Including Access Management)

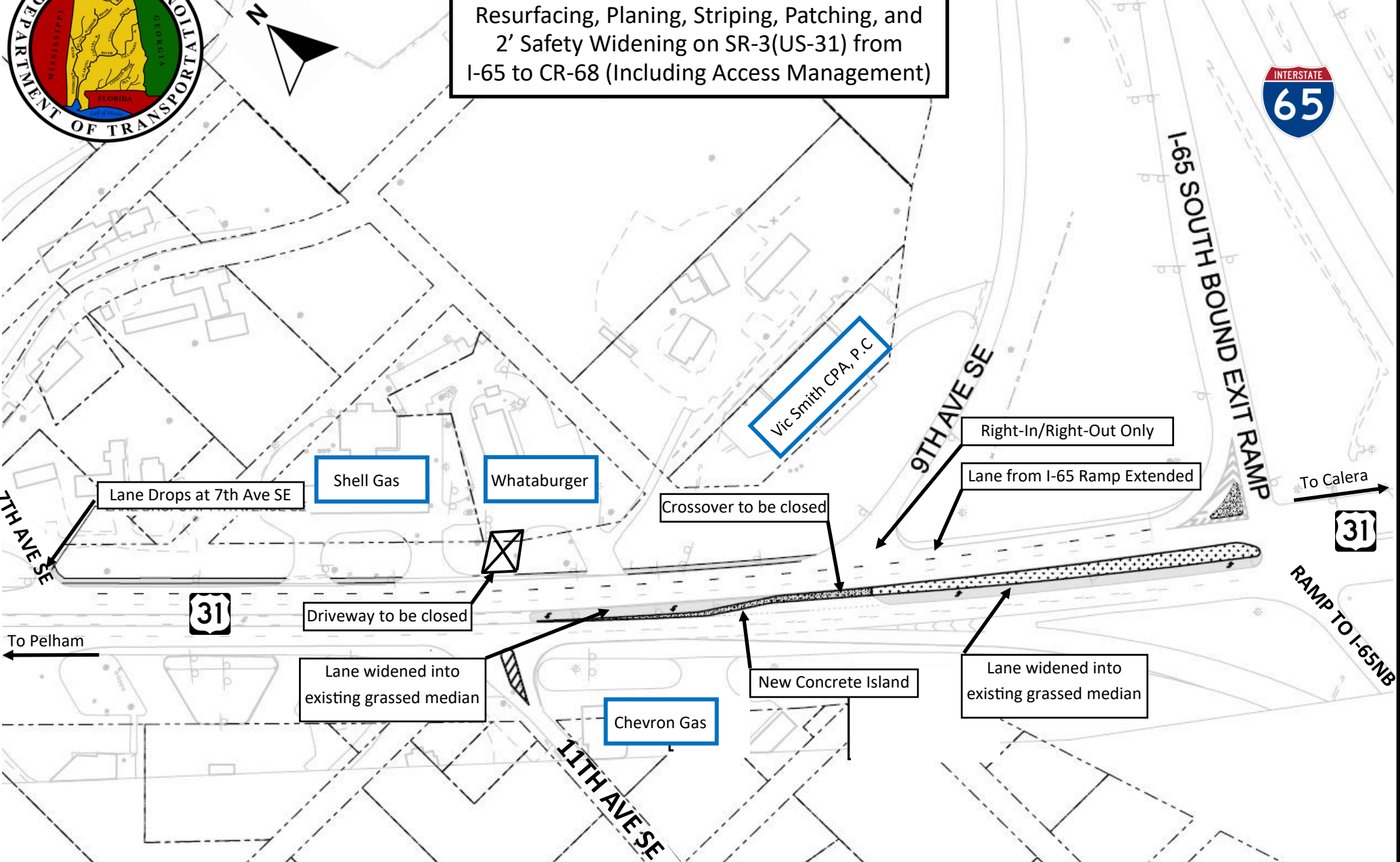

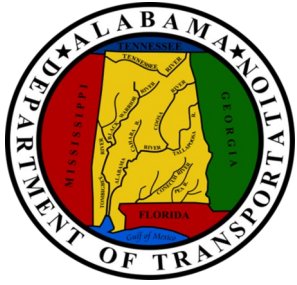

NH-0003(621)
Resurfacing, Planing, Striping, Patching, and
2' Safety Widening on SR-3(US-31) from
I-65 to CR-68 (Including Access Management)

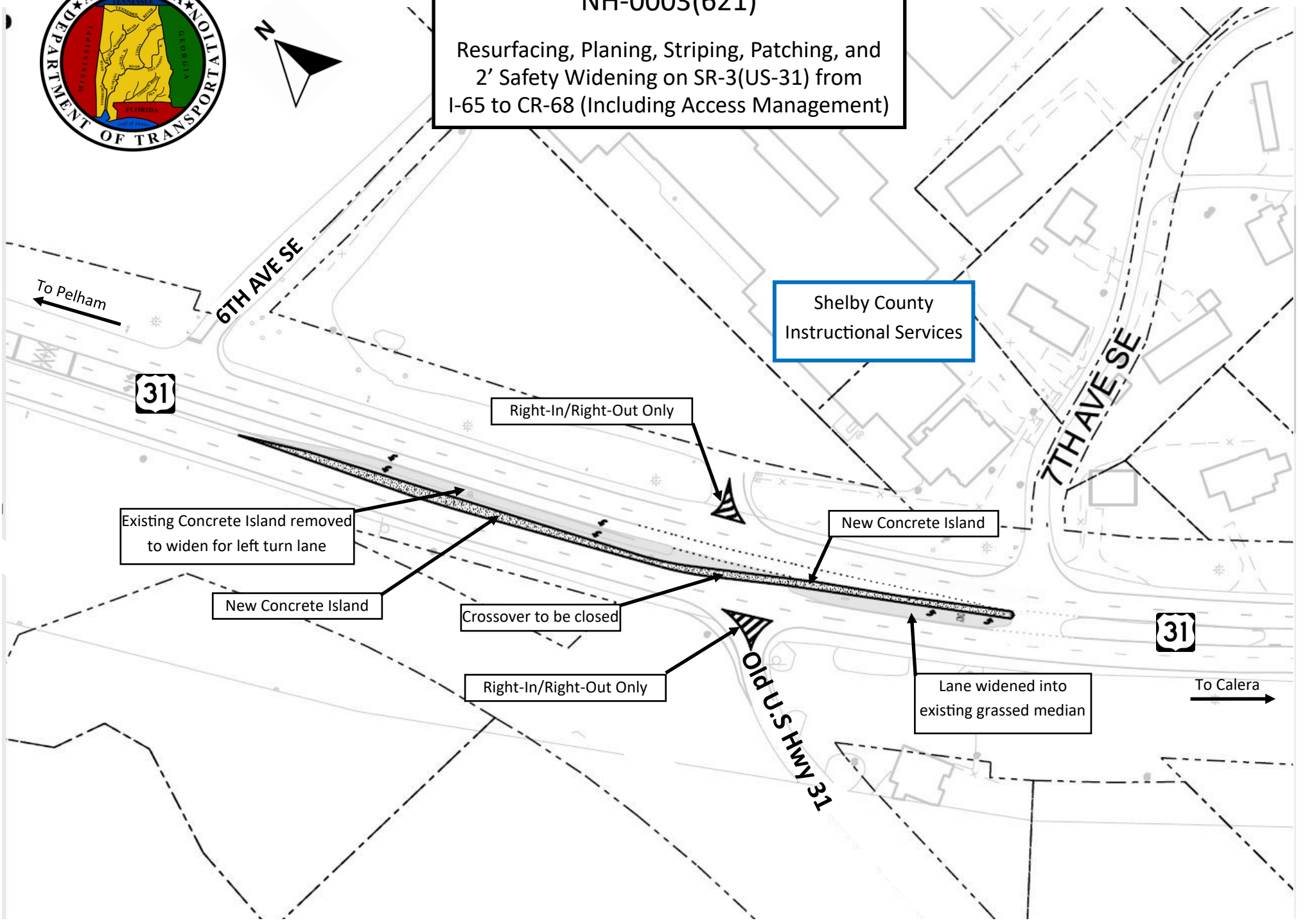

Shelby County
Instructional Services

31

Right-In/Right-Out Only

Existing Concrete Island removed
to widen for left turn lane

New Concrete Island

New Concrete Island

Crossover to be closed

Right-In/Right-Out Only

31

Lane widened into
existing grassed median

To Calera

Old U.S. Hwy 31

To Pelham

6TH AVENUE SE

7TH AVENUE SE

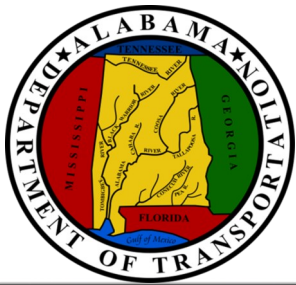

NH-0003(621)
Resurfacing, Planing, Striping, Patching, and
2' Safety Widening on SR-3(US-31) from
I-65 to CR-68 (Including Access Management)

