

ALDOT's Transit Vehicle Options

Floor plans and pictures shown below are **for information purposes only**. Vehicle types, configurations, and pricings are subject to change at the time of order. If additional information is requested, please contact Robert Echols, Procurement and Disposition Manager, at 334-242-6780.

6+2 – Low Floor BraunAbility Side Entry In-Floor Ramp – Non-CDL –6-4A

Sample Floorplan and Picture:

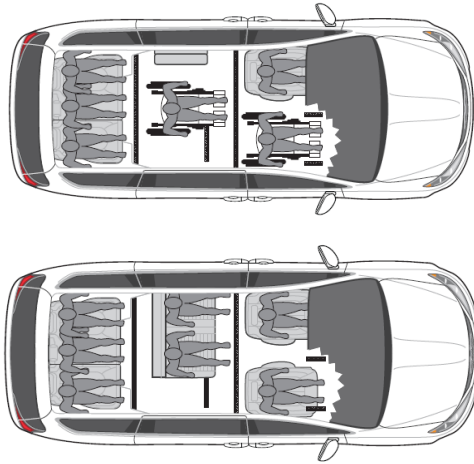

9+2 – Transit Bus Doors Gamechanger Wheelchair Entrance with Omni Floor – Non-CDL –6-4A

Sample Floorplan and Picture:

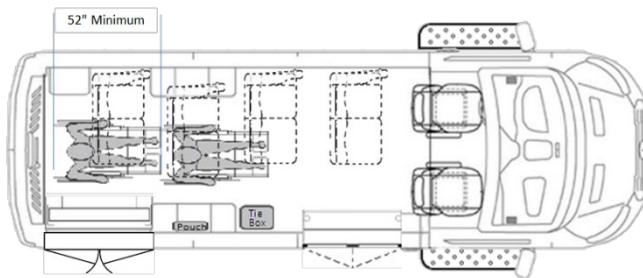

ALDOT's Transit Vehicle Options

9+2 – Low Floor BraunAbility Promaster – Non-CDL –6-3A

Sample Floorplan and Picture:

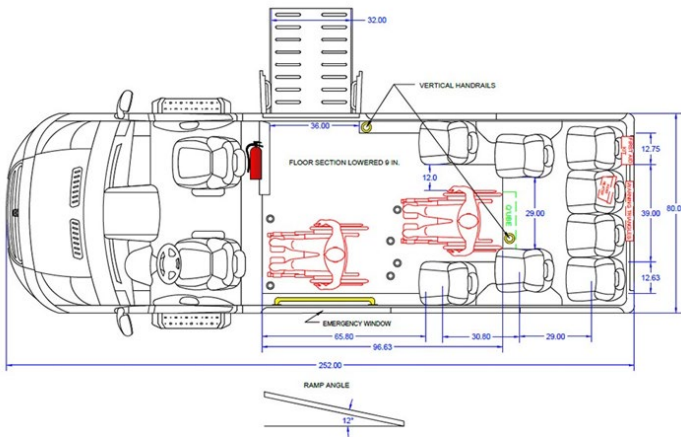

14 All Passenger Starcraft – Non-CDL – 4-5A

Sample Floorplan and Picture:

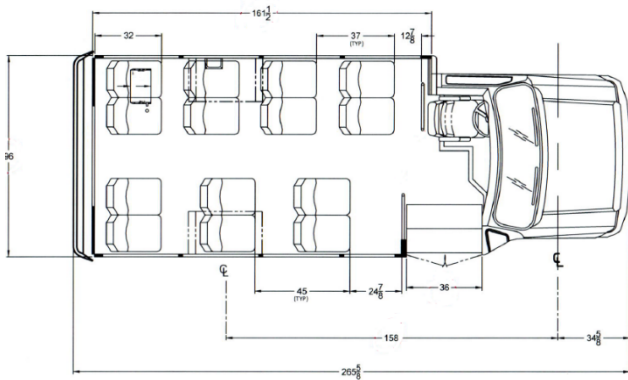

ALDOT's Transit Vehicle Options

14+2 Rear Lift Starcraft – Non-CDL –4-5A

Sample Floorplan and Picture:

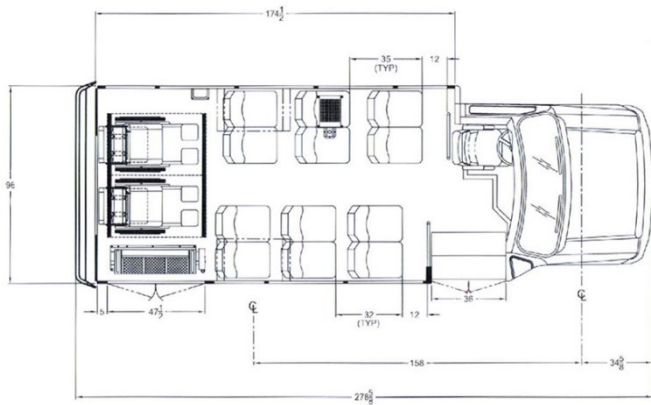

14+2 Front Lift Starcraft – Non-CDL – 4-6B

Sample Floorplan and Picture:

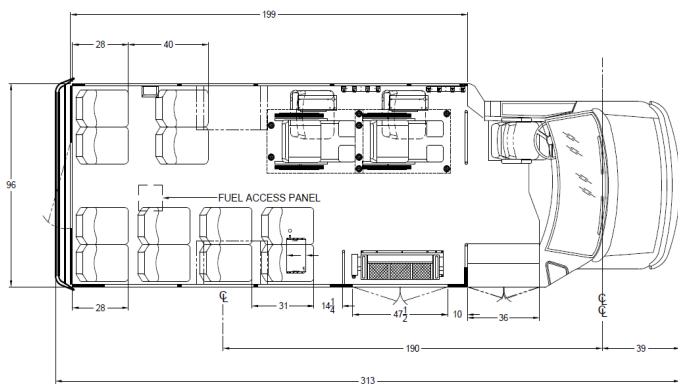

ALDOT's Transit Vehicle Options

12+2 Low Floor ARBOC – Non-CDL – 4-5B

Sample Floorplan and Picture:

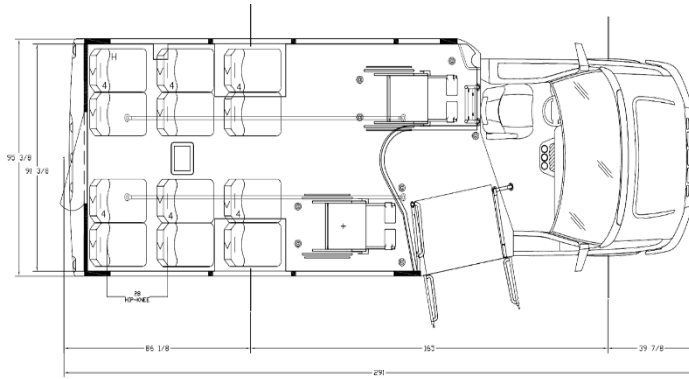

24 All Passenger Starcraft High-Back Recliners – CDL Required – 4-6B

Sample Floorplan and Picture:

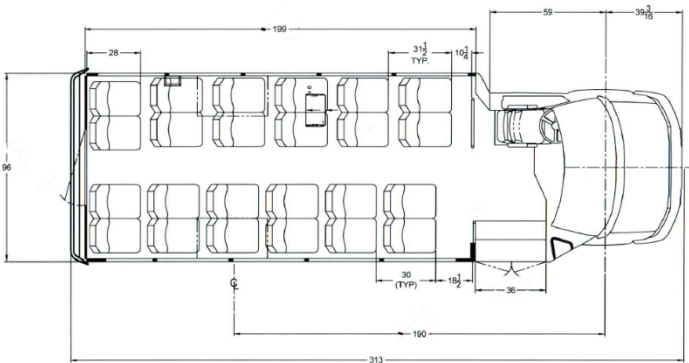

ALDOT's Transit Vehicle Options

20+2 Starcraft – CDL Required – 4-6B

Sample Floorplan and Picture:

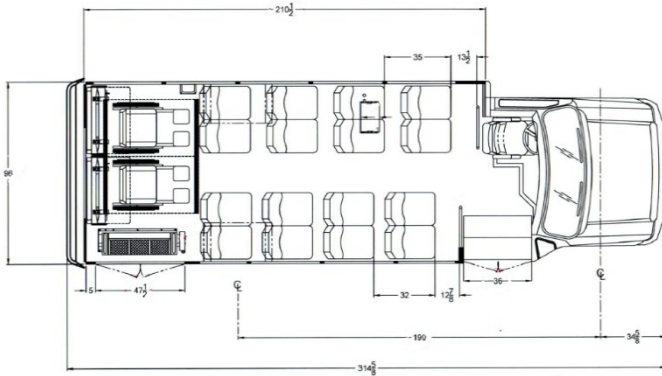

24+2 Starcraft – CDL Required – 4-6B

Sample Floorplan and Picture:

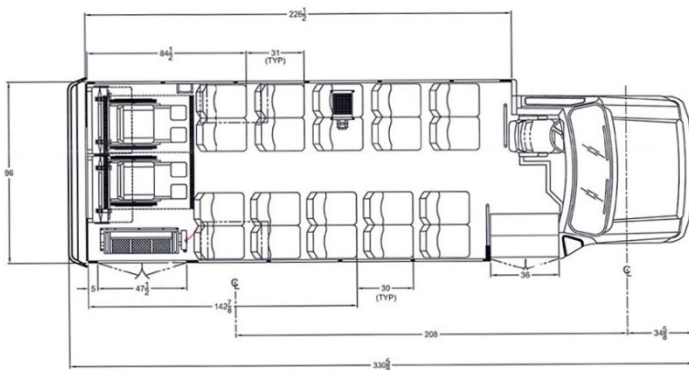

ALDOT's Transit Vehicle Options

30+2 Starcraft – CDL Required – 4-8B

Sample Floorplan and Picture:

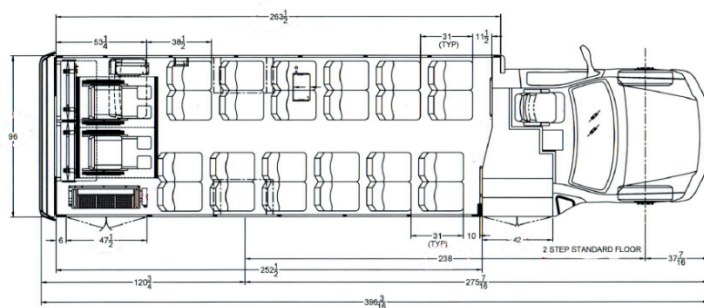

30+2 Starcraft – CDL Required – 4-8B – Diesel

Sample Floorplan and Picture:

