

6

JASON WATKINS

JONATHAN RASMUSSEN

LOCATION	PERSONNEL	CLASS	TRUCK NUMBER	HURRICANE RADIO NO.	SOUTHERN LINC NO.	MISC. EQUIPMENT
Site 6 Exit 54 CR-1	ANDRE AUSTIN	TMT III	ST-17374 CREW CAB	251-331-2432	251-331-2432	W/ TRAILER
	TAYLOR MITCHELL	TMT I				
	JAMIE HOWARD	TMT I				
	JEREMY MILLER	EA I				
	KENNY JAMES	TMT I	ST-17955 SERVICE TRUCK			W/ VMS

22	MOBILE AREA IN PLACE PERSONNEL
23	TL/ATL IN PLACE
26	READY TO IMPLEMENT
30	NOTIFY TL TO PROCEDURE
45	SB ATL PASSED
57	ATL'S NB HAVE PASSED
59	INTERCHANGE CLEAR
67	TRAFFIC REVERSED
104	INTERCHANGE CLEAR
114	TRAFFIC NORMAL

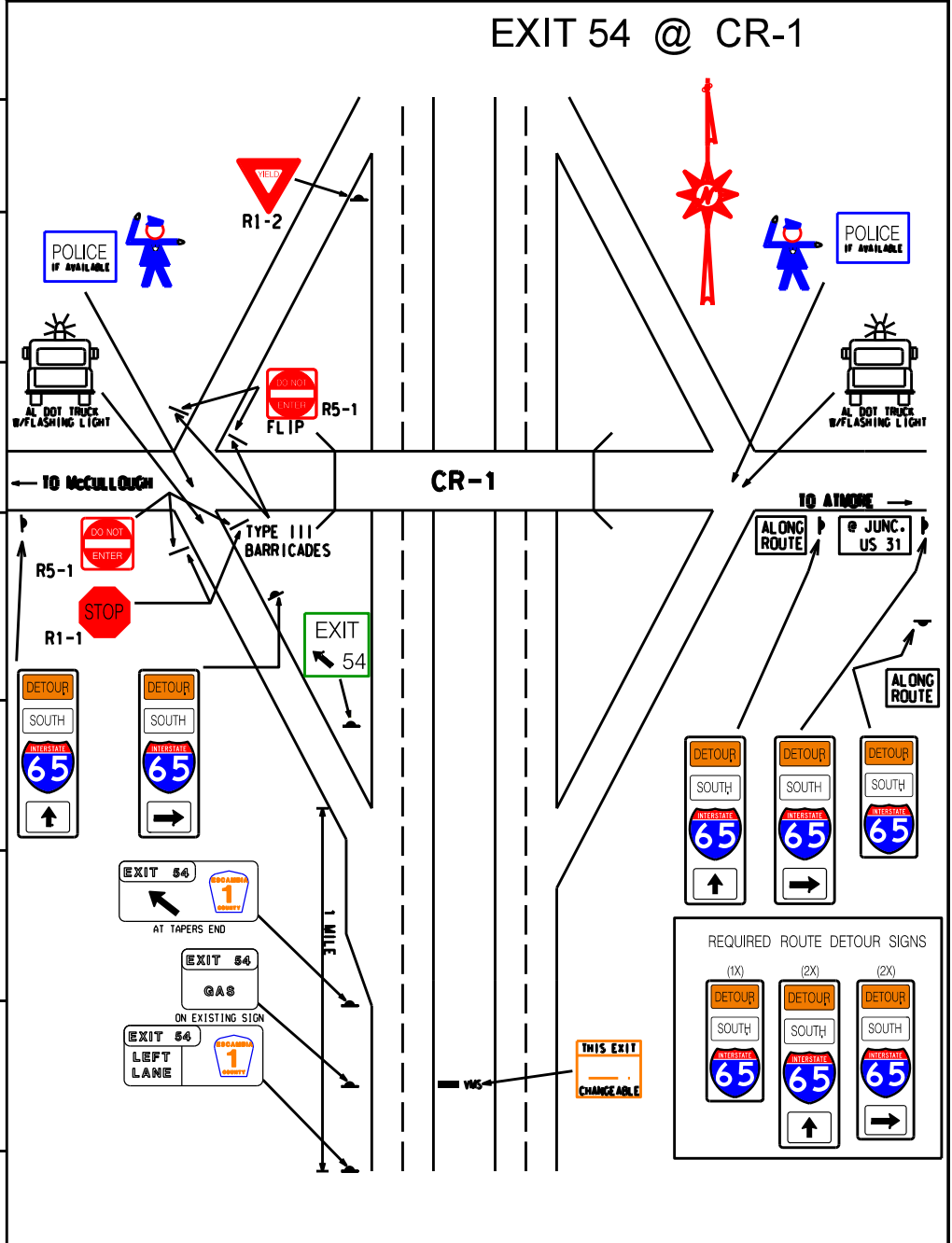

REQUIRED	
2	TYPE III BARRICADES W/STOP SIGNS W/DO NOT ENTER
1	YIELD SIGNS
2	LAW ENFORCEMENT
5	ROUTE DETOUR SIGNS
1	EXIT AHEAD SIGNS
1	EXIT LT. LN. SIGN
1	EXIT SERVICES SIGN
1	EXIT ARROW SIGN

NOTE : COVER ALL INAPPROPRIATE SIGNS