

# 10

# JASON DANIELS

334-850-7816

# KAITLYN MORGAN

205-270-3028

# ANDY LASTER

256-810-5752

22	<b>MOBILE AREA IN PLACE PERSONNEL</b>
23	<b>TL/ATL IN PLACE</b>
26	<b>READY TO IMPLEMENT</b>
30	<b>NOTIFY TL TO BEGIN PROCEDURE</b>
40	<b>ATL ARRIVES AT TYPE B INTERCHANGE</b>
48	<b>ATL ARRIVES AT TYPE B INTERCHANGE</b>
57	<b>ATL'S NB HAVE PASSED</b>
59	<b>INTERCHANGE CLEAR</b>
67	<b>TRAFFIC REVERSED</b>
104	<b>INTERCHANGE CLEAR</b>
114	<b>TRAFFIC NORMAL</b>

LOCATION	PERSONNEL	CLASS	TRUCK NUMBER	HURRICANE RADIO NO.	SOUTHERN LINC NO.	MISC. EQUIPMENT
Site 10 Exit 69 SR-113	MICHAEL KING	TMT II - CL	ST-15515 CREWCAB	251-581-0960	251-581-0960	TM/ARW BRD, W/TLR
	RODNEY HALL	TMT II				
	AVERY SMITH	EA III	ST-17300 PICKUP	251-331-2692	251-331-2692	
	QUENTIN LEE	TMT II	ST-17294 PICKUP			W/VMS

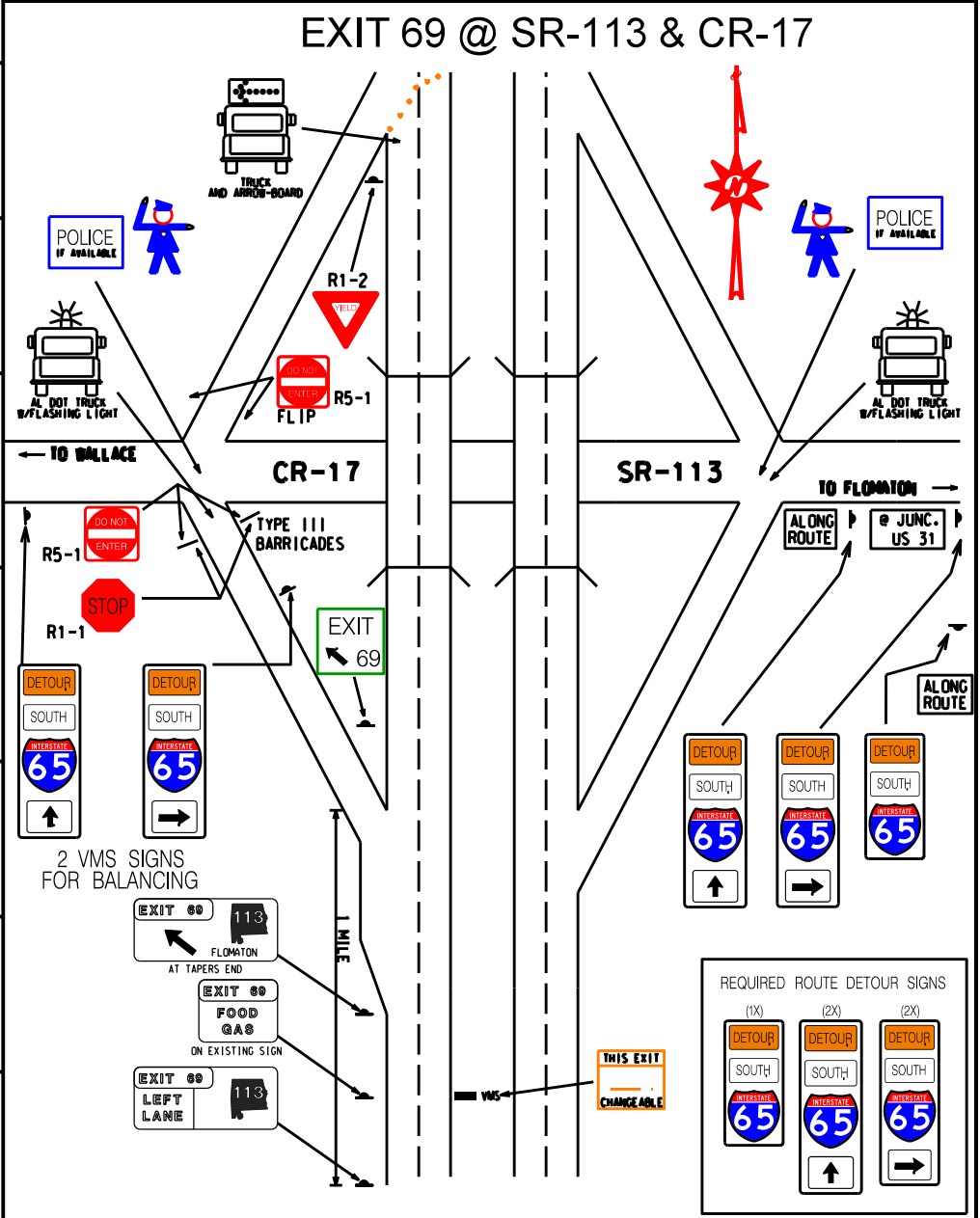

- | REQUIRED  |
|---|
| 2 TYPE III BARRICADES W/STOP SIGNS W/DO NOT ENTER |
| 1 YIELD SIGNS                                     |
| 2 LAW ENFORCEMENT                                 |
| 5 ROUTE DETOUR SIGNS                              |
| 1 EXIT AHEAD SIGNS                                |
| 1 EXIT LT. LN. SIGN                               |
| 1 EXIT SERVICES SIGN                              |
| 1 EXIT ARROW SIGN                                 |
| 2 ALL TRAFFIC MUST EXIT 1/2 MILE SIGNS            |
| 2 ALL TRAFFIC MUST EXIT 1 MILE SIGNS              |

NOTE : COVER ALL INAPPROPRIATE SIGNS