

# 15

# HIRAM GARNER

22	<b>MOBILE AREA IN PLACE PERSONNEL</b>
23	<b>TL/ATL IN PLACE</b>
26	<b>READY TO IMPLEMENT</b>
30	<b>NOTIFY TL TO BEGIN PROCEDURE</b>
40	<b>ATL ARRIVES AT TYPE B INTERCHANGE</b>
48	<b>ATL ARRIVES AT TYPE B INTERCHANGE</b>
57	<b>ATL'S NB HAVE PASSED</b>
59	<b>INTERCHANGE CLEAR</b>
67	<b>TRAFFIC REVERSED</b>
104	<b>INTERCHANGE CLEAR</b>
114	<b>TRAFFIC NORMAL</b>

LOCATION	PERSONNEL	CLASS	TRUCK NUMBER	HURRICANE RADIO NO.	SOUTHERN LINC NO.	MISC. EQUIPMENT
Site 15 Exit 101 CR-29	REX WILCOX	TMT II - CL	ST-17801 CREWCAB	251-254-1665	251-254-1665	W/TRAILER, W/TCE
	HANK STINSON	TT	ST-16835 PICKUP	251-238-4635	251-238-4635	W/VMS, W/TCE
	DAVID LANKFORD	TMT I				
	DOYLE BAGGETT	TMT II				

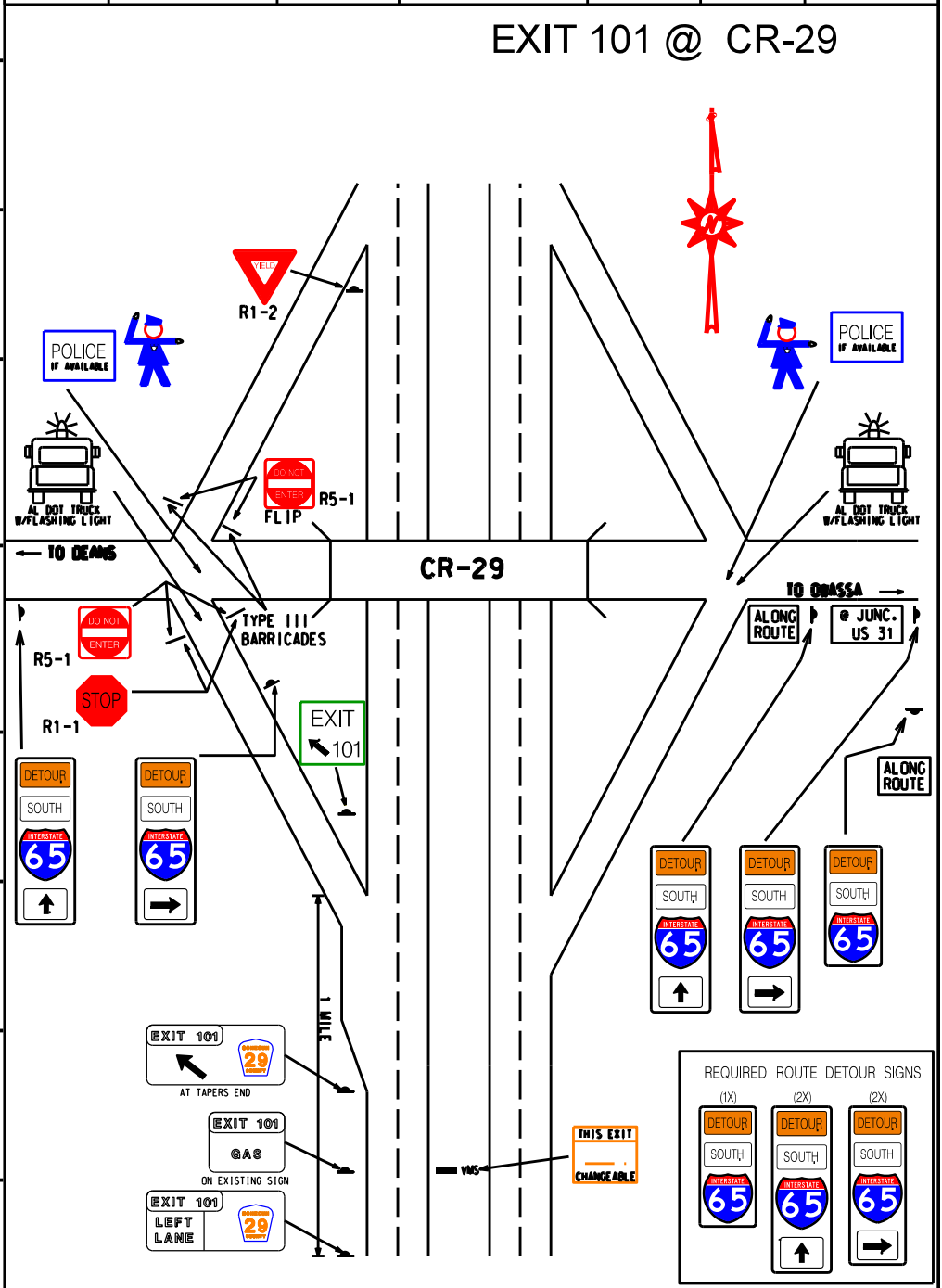

REQUIRED	
2	TYPE III BARRICADES W/STOP SIGNS W/DO NOT ENTER YIELD SIGNS
1	LAW ENFORCEMENT
5	ROUTE DETOUR SIGNS
1	EXIT AHEAD SIGNS
1	EXIT LT. LN. SIGN
1	EXIT SERVICES SIGN
1	EXIT ARROW SIGN

NOTE : COVER ALL INAPPROPRIATE SIGNS