

TEMPORARY TRAFFIC CONTROL PLAN SHEET

REFERENCE PROJECT NO	FISCAL YEAR	SHEET NO

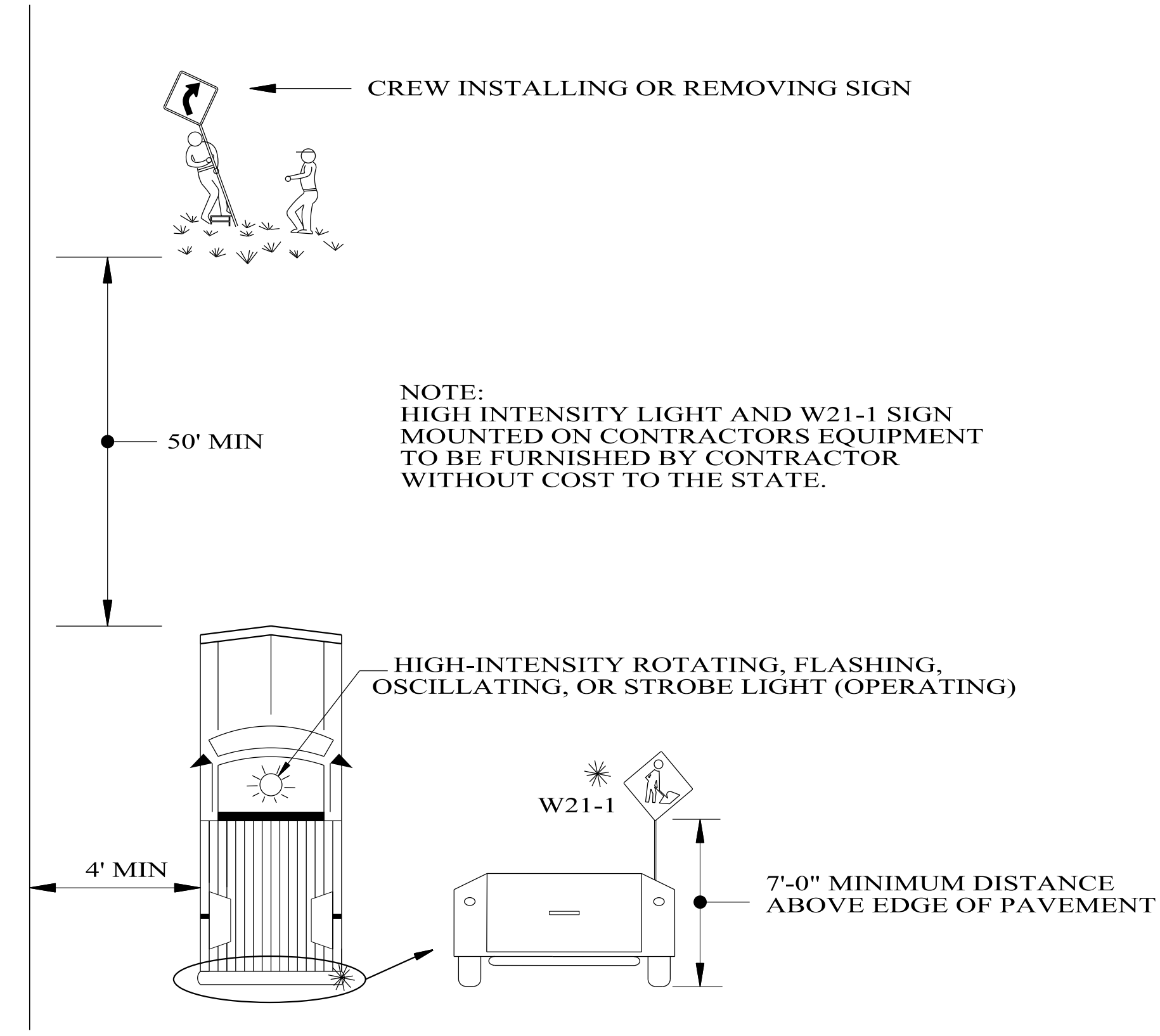

TYPICAL METHOD FOR INSTALLING OR REMOVING CONSTRUCTION SIGNS

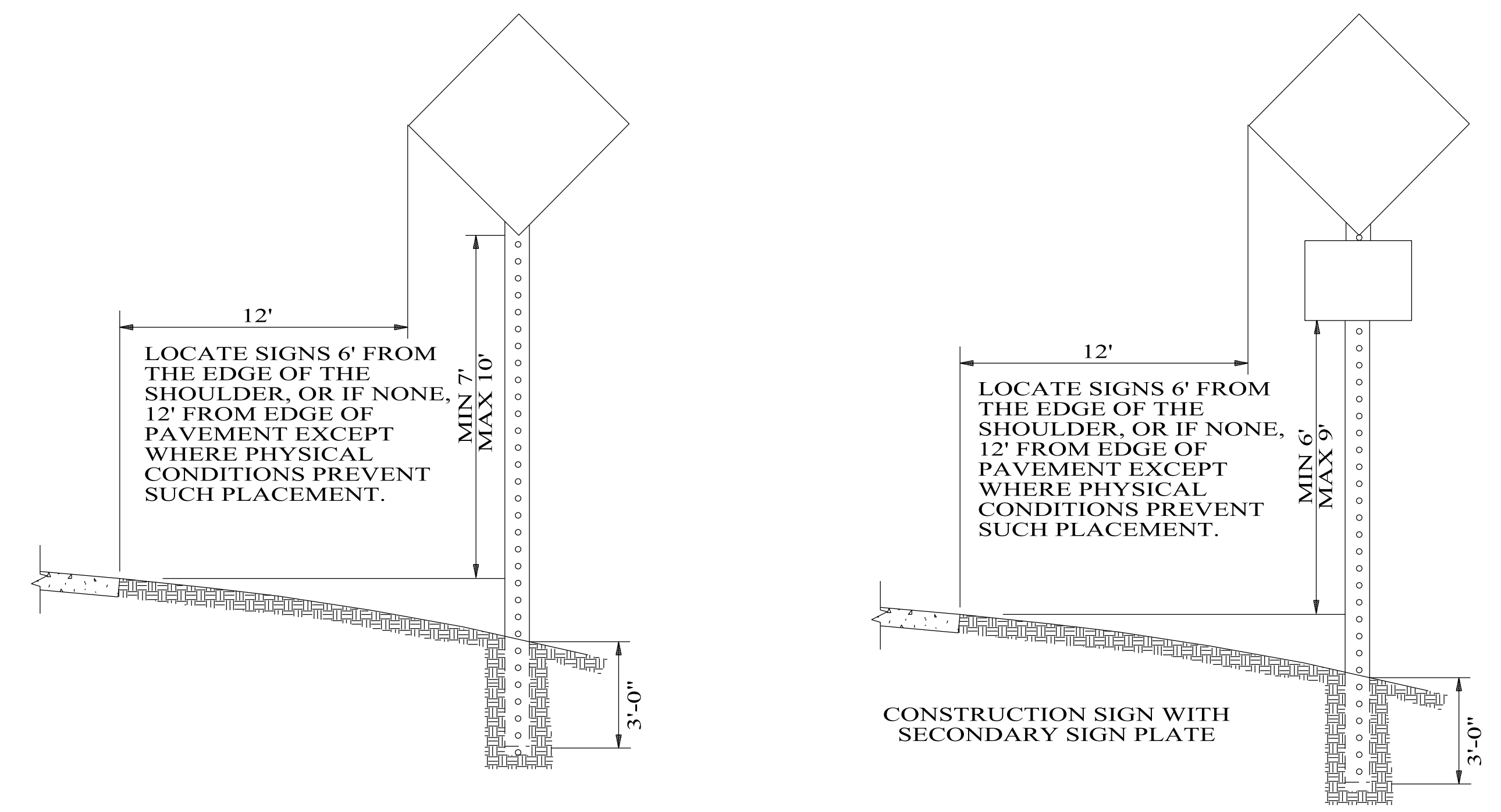

NOTE:
IF THE CONTRACTOR CHOOSES TO SPLICE THE POSTS FOR THE REQUIRED POST MOUNTED CONSTRUCTION SIGNS, THEY SHALL BE SPLICED AS SHOWN ON DRAWING IHS-710-23.

HEIGHT AND LATERAL LOCATION OF POST MOUNTED CONSTRUCTION SIGNS

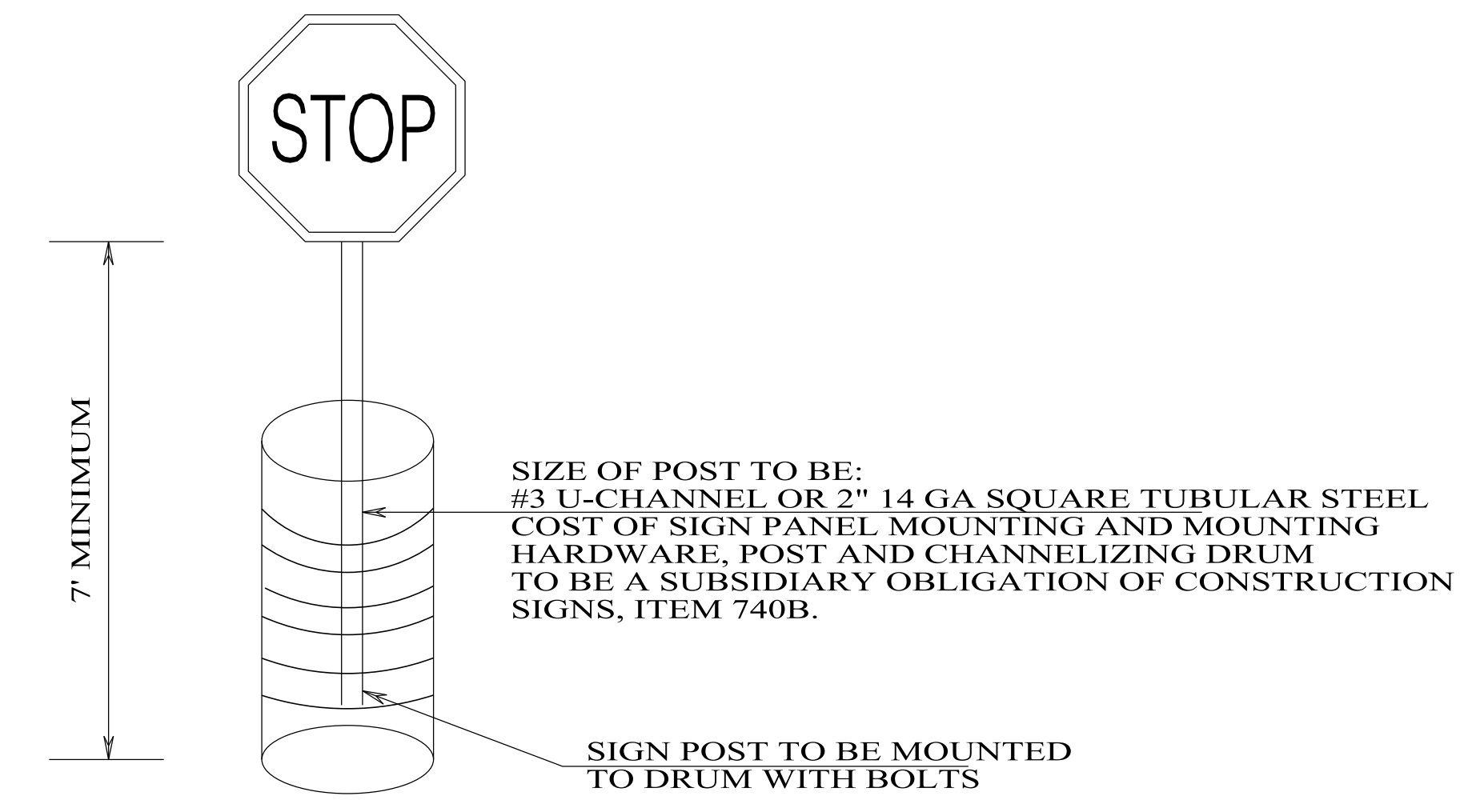

DETAIL FOR DRUM MOUNTED CONSTRUCTION SIGNS