

# 10

# JASON DANIELS

## SYDNEY CULLBRETH

## KAITLYN MORGAN

22	<b>MOBILE AREA IN PLACE PERSONNEL</b>
23	<b>TL/ATL IN PLACE</b>
26	<b>READY TO IMPLEMENT</b>
30	<b>NOTIFY TL TO BEGIN PROCEDURE</b>
40	<b>ATL ARRIVES AT TYPE B INTERCHANGE</b>
48	<b>ATL ARRIVES AT TYPE B INTERCHANGE</b>
57	<b>ATL'S NB HAVE PASSED</b>
59	<b>INTERCHANGE CLEAR</b>
67	<b>TRAFFIC REVERSED</b>
104	<b>INTERCHANGE CLEAR</b>
114	<b>TRAFFIC NORMAL</b>

LOCATION	PERSONNEL	CLASS	TRUCK NUMBER	CELL NO.	MISC. EQUIPMENT
Site 10 Exit 69 SR-113	MICHAEL KING	TMT II - CL	ST-17496 CREWCAB	251-895-0587	TM/ARW BRD, W/TLR
	LAPRINCETON WILE	TMT I	ST-18053 VAN	251-895-3972	
	MIKE BLACKMON	EA III	ST-18184 PICKUP	251-895-9441	W/VMS
	WILLIE MCCASKILL	EA I		251-895-4593	

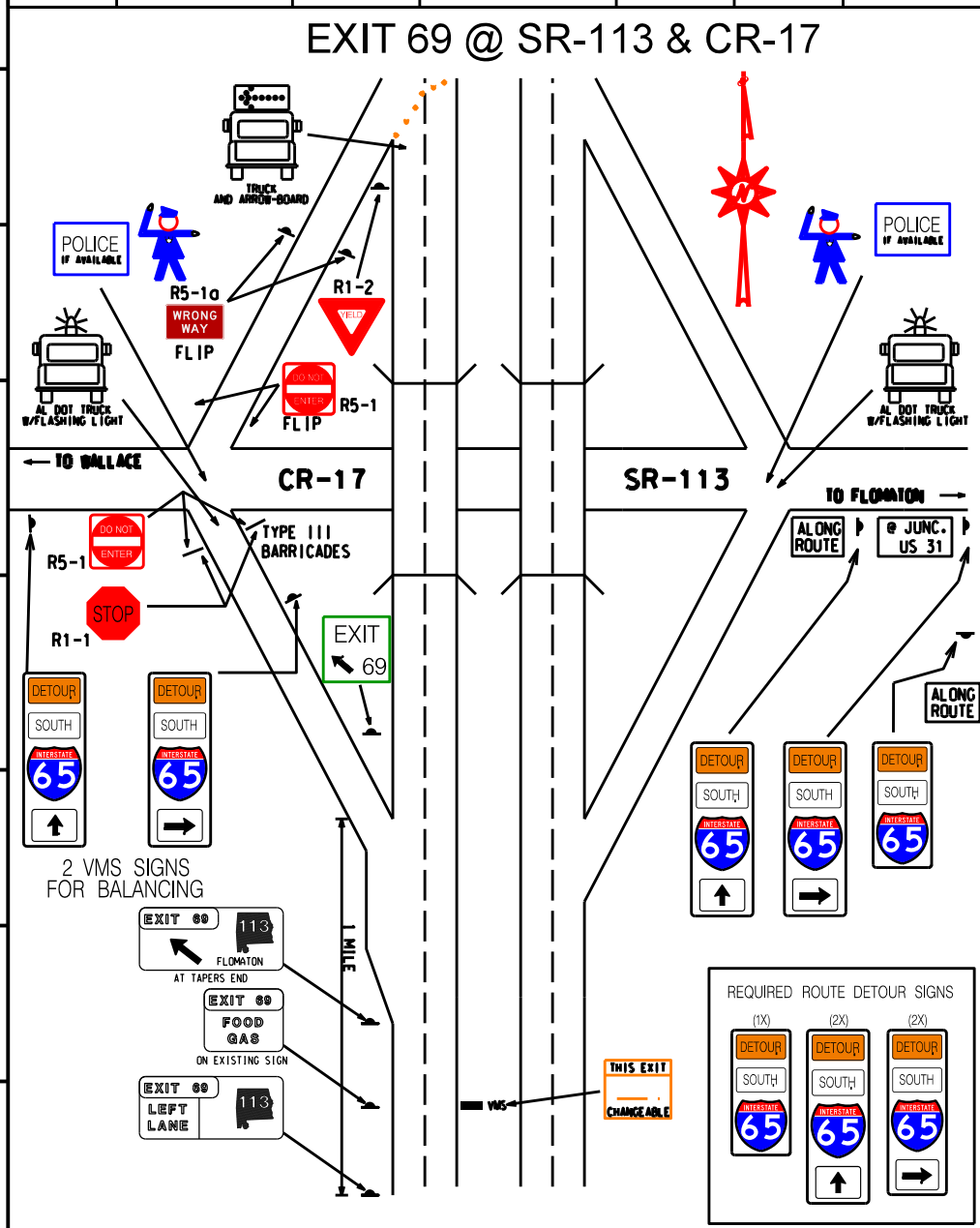

REQUIRED	
2	TYPE III BARRICADES W/STOP SIGNS W/DO NOT ENTER
1	YIELD SIGNS
2	LAW ENFORCEMENT
5	ROUTE DETOUR SIGNS
1	EXIT AHEAD SIGNS
1	EXIT LT. LN. SIGN
1	EXIT SERVICES SIGN
1	EXIT ARROW SIGN
2	ALL TRAFFIC MUST EXIT 1/2 MILE SIGNS
2	ALL TRAFFIC MUST EXIT 1 MILE SIGNS

NOTE : COVER ALL INAPPROPRIATE SIGNS