

# 11

# TODD CONNELL DEWAYNE EHLERS

22	<b>MOBILE AREA IN PLACE PERSONNEL</b>
23	<b>TL/ATL IN PLACE</b>
26	<b>READY TO IMPLEMENT</b>
30	<b>NOTIFY TL TO BEGIN PROCEDURE</b>
40	<b>ATL ARRIVES AT TYPE B INTERCHANGE</b>
48	<b>ATL ARRIVES AT TYPE B INTERCHANGE</b>
57	<b>ATL'S NB HAVE PASSED</b>
59	<b>INTERCHANGE CLEAR</b>
67	<b>TRAFFIC REVERSED</b>
104	<b>INTERCHANGE CLEAR</b>
114	<b>TRAFFIC NORMAL</b>

LOCATION	PERSONNEL	CLASS	TRUCK NUMBER	CELL NO.	MISC. EQUIPMENT
Site 11 Exit 77 SR-41	MICHAEL GRIFFIN	TMT III - CL	ST-17497 CREWCAB	251-895-6311	TM/ARW BRD, W/TLR
	RICHARD BROWN	TMT II	ST-18951 PICKUP		W/VMS
	VICTOR OLIVER	TMT I			

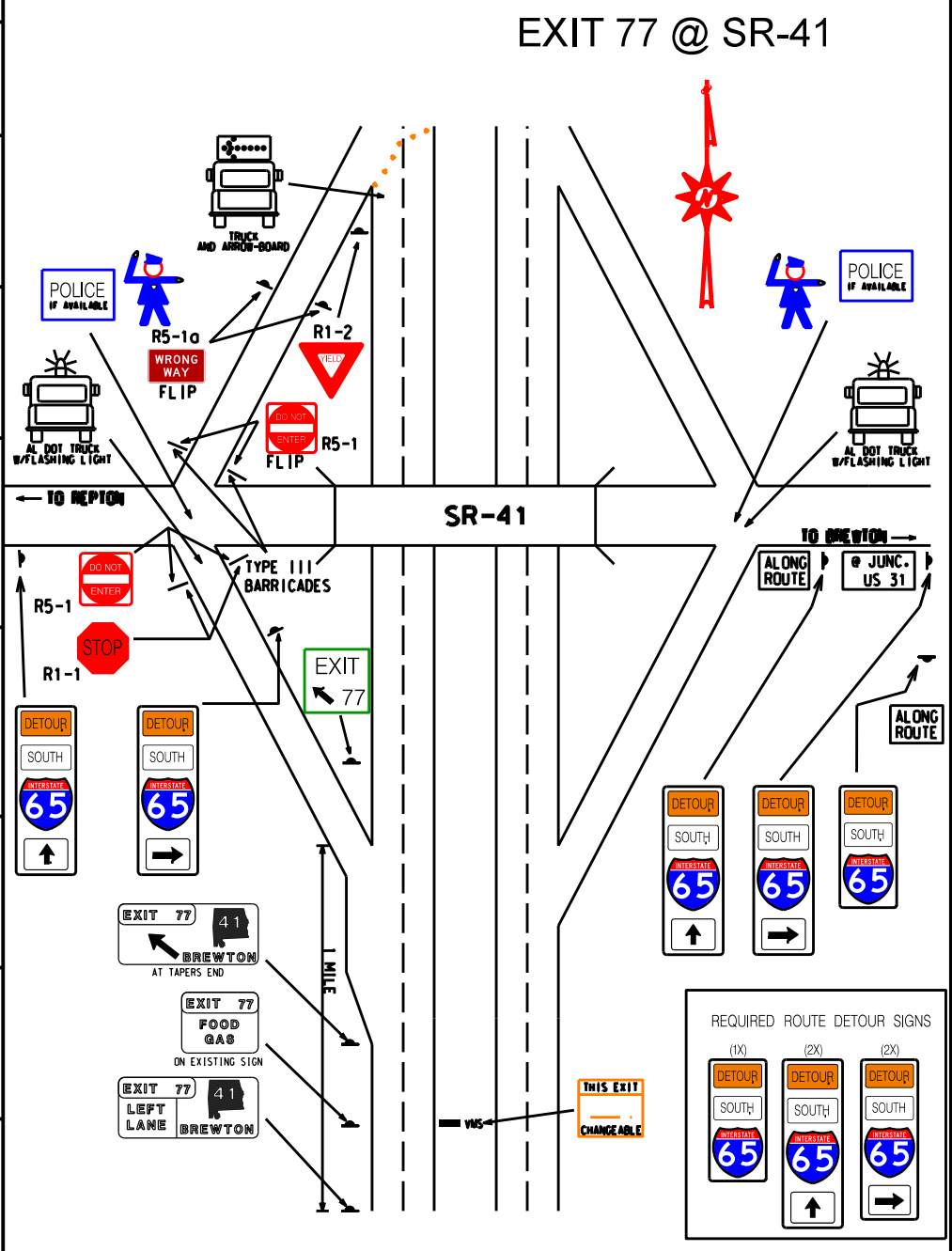

REQUIRED	
2	TYPE III BARRICADES W/STOP SIGNS W/DO NOT ENTER
1	YIELD SIGNS
2	LAW ENFORCEMENT
5	ROUTE DETOUR SIGNS
1	EXIT AHEAD SIGNS
1	EXIT LT. LN. SIGN
1	EXIT SERVICES SIGN
1	EXIT ARROW SIGN
2	ALL TRAFFIC MUST EXIT 1/2 MILE SIGNS
2	ALL TRAFFIC MUST EXIT 1 MILE SIGNS

NOTE : COVER ALL INAPPROPRIATE SIGNS

